



OVERALL LENGTH
W/STD 24" INTEGRAL
SWIM PLATFORM

40'
12.2 M

OVERALL LENGTH
W/OPT EXT/HYD
SWIM PLATFORM

43'6"
13.26 M

○ ARCTIC WHITE ● BLACK ● BLUE ● HORIZON ● PATINA

BEAM	13'6" / 4.11 M
DRY WEIGHT (STERNDRIVES)	28,517 LB / 12,935 KG
DRY WEIGHT (INBOARDS)	TBD
DRAFT (STERNDRIVES)	40" / 101 CM
DRAFT (INBOARDS)	40" / 101 CM
DEADRISE	17°
HOLDING TANK	42 GAL / 159 L

The specification measurements are approximations and subject to variance.



320 GAL
1,211 L



100 GAL
378 L



6
PEOPLE

400 SUNDANCER FEATURES

- ≈ Sterndrive or V-drive propulsion, gas or diesel
- ≈ Social daytime & intimate nighttime layout
- ≈ Standard Raymarine® e125 widescreen chartplotter with radar
- ≈ Stereo with Wireless Bluetooth™ and media inputs
- ≈ Superior sun coverage w/foredeck shade and cockpit SureShade®
- ≈ Master stateroom with expansive closet system, or, optional second fully appointed head & shower

STANDARD PROPULSION

Twin MerCruiser® 8.2 MAG HO
Axius® Propulsion w/Bravo® IIIx
(T-430 hp - 321 kW)

Sea Ray®

LAUNCH INTO LIVING

400 SUNDANCER®

FEATURES & STANDARD EQUIPMENT

HULL & DECK FEATURES

Bottom Paint
Bow Rail, 316 Stainless Steel w/Welded Stanchions
Cleats, Custom Sea Ray 10" Thru-Bolted, Stainless Steel (8)
Deck Fill Plates, Stainless Steel
Deck Rails, 316 Stainless Steel
Drain Plug, Threaded Brass - Garboard
Gel Coat Exterior Finish
Graphics, Striping
Handrails, 316 Stainless Steel
Hatch, Deck Vent - Translucent w/Locks & Sky Screen Cover
Hull Windows, Extra Large Fixed, One Opening w/Screen Light, Stern
Lights, Navigation
Recessed Bow Seating, w/Sunpad & Folding Backrest,
Stainless Steel Deck Runners w/Beverage Holders
Rub Rail, PVC w/Stainless Steel Insert
Spotlight w/Dual Halogen Bulbs -Remote Controlled
Storage, Transom Wall for Fenders & Gear
Swim Platform, Integral w/Concealed Swim Ladder
Thru-Hull Fittings, Stainless Steel
Toe Rail, Molded Fiberglass - Deck
Vent System, Engine Room - Integral w/Stainless Steel Accents
Windshield, Tempered/Tinted Curved Glass (Bonded-In)
Windshield Wipers - Self Parking

CANVAS (SUNBRELLA®)

Canvas Colors - Blue, Black or Taupe
Canvas Bow Sunpad Cover
Canvas Cockpit Seat Covers

CERTIFICATIONS:

Meets Applicable USCG & ABYC Standards
NMMA Certification
Meets CE Category B

MOORING SYSTEM:

Anchor, Galvanized
Anchor Chute, Stainless Steel
Anchor Rope/Chain Storage w/Gas Assisted Hatch
Windlass, Rope/Chain w/Foot Switches

COCKPIT FEATURES

Beverage Holders
Coolers (2), Carry-On w/Designated Storage
Door, Cabin Entry, Lockable, with Flush Threshold
Door, Transom - Acrylic w/Stainless Steel Frame
Floor Liner, Fiberglass - Self-Bailing
Handrails, 316 Stainless Steel
Hatch, Engine Room - Electrically Actuated w/Emergency Support Arm
Lighting, Indirect
Outlet, 120V GFI Protected
Seating, Port w/Cup Holders & Storage Below
Seating with Storage
Steps, Boarding, Molded-In
Storage - Fenders & Gear

CABIN FEATURES

Carbon Monoxide Monitor
Lighting, Direct & Indirect
Lighting, LED Accents
Outlets, 120V GFI Protected
Pillows, Accent
Seating, Allante Fabric Interior
Shades, Curtains - Hull Windows
Stereo, 12V AM/FM, Wireless Bluetooth™, iPod Connector, Amplifier, Speakers (Cockpit, Salon), Digital Helm Remote Control & Speaker Selector Switches
Storage, In-Floor
Vacuum System, Central, 120V
Wood Cabinetry: Chestnut

SUNROOM (ENCLOSED):

Blinds, Honeycomb, for Port & Starboard Windows
Curtain, Privacy - Aft Sunroom Door
Flooring, Wood
Lighting 12V
Ottoman, Reversible, for Sofa
Seating, Sofa
Sunroof, Opening Electric
Storage
Table, Sofa End w/Solid Surface
TV, LED / Smart w/Remote Blu-ray™ Player, Gaming System Port, DVD Storage, Coax Outlet & Gain Control

HELM AREA:

Cup Holders (5)
Flooring, Wood
Seating, Bench Style Seating for Two
Storage

GALLEY:

Countertop, w/Stainless Steel Sink & Single Lever Faucet
Flooring, Wood
Lighting, 12V
Microwave, 120V
Outlet 12V - Accessory
Power Vent, 12V
Refrigerator/Freezer Combo - Dual Voltage 120V/12V
Storage, Upper w/Cutlery Insert
Storage, Lower Drawers and Upper Recessed Bottle Storage
Stove, 120V Flush Two Burner
Trash Receptacle

AFT STATEROOM:

Berths, 3 Twins (Forward Berth Slides Aft to Convert to Larger Bunk)
Door, Privacy
Flooring, Carpet
Pillows, Sheets, & Coordinated Spread
Sheet Set, Fitted (Neutral Color)
Storage, Large and Small Trays and Under Bunk
Storage - Hanging Locker

FORWARD STATEROOM:

Berth, Double Island Style w/Visco Elastic Foam Mattress & Storage Below
Door, Privacy
Flooring, Carpet
Pillows, Sheets, & Coordinated Spread
Sheet Set, Fitted (Neutral Color)
Storage, Drawers Under Berth
Storage, Hanging Locker
TV, 24" LED / Smart w/Remote Blu-ray™ Player

HEAD / SHOWER:

Bathroom Tissue Holder
Door, Privacy
Flooring, Simulated Teak Tile
Head, Enclosed -Full Fiberglass w/Separate Shower Stall & Shower Door
Head, VacuFlush®
Mirror, Vanity
Portlight, Opening w/Screen
Power Vent, 12V
Shower Wand w/Vertical Adjustment
Storage, Medicine Cabinet
Storage, Upper Shelves w/Stainless Steel Rails - Shower Area
Towels - Sea Ray
Vanity w/Sink, Single Lever Faucet & Storage Below

TECHNICAL FEATURES

AIR CONDITIONING/HEATING:

Zone-Controlled Reverse-Cycle System (27,000 BTU - Upper; 16,000 BTU - Lower) w/Custom Integral Vent System

HELM:

Alarms, High-Water - Bilge & Cabin
Compass
Defroster
Digital Remote Control for Stereo
Emergency Start System (Battery Paralleler) - Engines Horn
Instrument Panels
Joystick Control, Axis®
SmartCraft® Diagnostics:

- Instrumentation, Custom Sea Ray® SmartCraft w/Low-Glare Blue Night Lighting & Chrome Bezels
- 4-in-1 Multigauges (2) (Includes: Fuel Level, Oil Pressure, Voltmeter & Water Temperature)
- Tachometers (2)

SmartCraft VesselView Display:

- Active Alarms/Details
- Alarm History/Details
- Environment & Navigation: GPS Interface, Depth & Water Temperature, Depth Alerts, Trip Log Information, Fuel to Waypoint Data & Navigational Data
- Propulsion Engine Hours Meters, Engine Status, Performance & Fuel, Peak Performance, Boost Pressure (Optional), Troll Control & Cruise Control
- Vessel: (Vessel) Status, Tank Status, Steering Position, Generator Data & Start/Stop

SmartCraft Digital Throttle & Shift (DTS) w/Power Tilt & Trim Control
Steering, Power Assisted, Stainless Steel Tilt Wheel w/Vinyl Grips
Switch Panel w/Illuminated Weatherproof Rockers
Windshield Wipers with Wiper Controls

ELECTRICAL SYSTEMS:

Battery Charger/Converter, 120V/40 Amp/12V
Battery Solenoid Switches (4)
Battery Trays w/Mounts
Breaker Panels, Waterproof - Power Module Enclosures & Dash Dimmer (Helm & Engine Room)
Cable TV System w/Inlet, TV Shore Cord, Coax Outlets, Gain Control & Omni Directional Antenna
Galvanic Isolators (2)
Mercathode II (Sterndrives Only)
Panel, DC Main Breaker
Panel, Main Distribution - AC w/Voltage & Current Meters
Panel, Main Distribution - DC w/Voltage & Current Meters
Shore Power, 240V/50 Amp w/50' Cord & Glendenning® Cablemaster
Wiring, Color-Coded w/Chafe Protection

ELECTRONICS:

Electronics Circuit, 30 Amp/12V w/Fuse Panel
Raymarine® e125 Widescreen 12.1" Color LCD, GPS/Chartplotter w/Integrated 4-kW HD Closed Dome Radar
VHF Radio w/8' Fiberglass Antenna

ENGINE ROOM:

Bilge Pump, 12V Automatic
Bilge Pumps, 12V Automatic High- Water (1 Bilge, 1 Cabin) Blowers, 12V Bilge (2)
Fire Suppression System - Automatic w/Manual Pull Gel-Coated Engine Room
Insulation, Engine Room - 1"
Lighting, 12V
Step, Engine Room Access
Underwater Exhaust, Patented (Optional V-Drives Only)

400 SUNDANCER®

FUEL SYSTEM:

Fuel Lines, USCG - Type A-1
Fuel Tank(s) Aluminum w/Electric Shutoff Valves & Mechanical Sending Units

GENERATOR:

10.0 kW (11 kW w/Diesel Eng); SmartCraft Interfacing
(240V/60 Cycle) w/Remote Start, Muffler, Closed Cooling,
Fuel Filter, Seacock & Seawater Strainer

UNDERWATER GEAR:

Propellers, Stainless Steel
Trim Tabs, Hydraulic
V-Drive Inboards (Optional):

- Bonding System w/Zinc Hull Plate
- Propellers, Nibral 3-Blade
- Propeller Shafts, 1.75" Stainless Steel (2) - Aqualloy 19
- Rudders, Manganese-Bronze
- Seacocks - Engines
- Seawater Strainers - Engines
- Shaft Logs, Dripless w/Extra Seal Carrier Kit
- Struts, Manganese-Bronze

WASTE SYSTEM:

Head System (VacuFlush®)
Holding Tank Level Indicators - MDP
Holding Tank w/Dockside Pump-Out (42 gal)
Sump Box w/Pump - Automatic

WATER SYSTEM:

Freshwater Washdown Spigot - Transom
Manifold System w/Shutoff Valves
Pressure Water System w/High Volume 12V Pump
Shower, Cockpit - Single-Lever Hot & Cold, Stainless Steel Door
Water Heater, 120V (11 Gallon)
Water Inlet, Dockside
Water Tank (100 gal)

STANDARD PROPULSION

TWIN GASOLINE AXIUS® PROPULSION:

T-MerCruiser® 8.2 MAG HO ECT* Bravo IIX w/Axius
(T-430 php - 321 kW)

*Non-catalyzed engines available for select international markets. Consult your local dealer for availability.

OPTIONS & ACCESSORIES

OPTIONAL PROPULSION

TWIN DIESEL AXIUS STERNDRIVES:

T-Mercury® 370 Diesel TDI 4.2L T3 Bravo IIXR w/Axius
(T-370 hp - 276 kW)

TWIN GASOLINE V-DRIVES:

T-VD-MerCruiser 8.2 Horizon ECT w/DTS
(T-425 hp - 317 kW)

TWIN DIESEL V-DRIVES:

T-VD-Cummins® QSB 480 6.7 HO
(T-480 hp - 358 kW)

ELECTRONICS OPTIONS

Autopilot, Raymarine® P70R (V-Drive Only - Interfaced w/
Chartplotter)
Raymarine CP 300 Fishfinder Module for e125 Display
Raymarine e125 Widescreen 12.1" Color LCD GPS/Chartplotter
- Auxiliary Display
Raymarine Network Camera - Bilge
Raymarine Open Array Radar Scanner (In-lieu-of Closed
Array)

INDIVIDUAL OPTIONS

Anchor, Stainless Steel (In Lieu of Galvanized)
Anchor Washdown System
Audio System for Foredeck Seating
Audio Upgrade Exterior, Cockpit Premium Sound System
(Includes Remote Control Unit on Transom)
Audio Upgrade Interior, Premium Cabin Sound System
w/AM/FM/CD/DVD Player, Upgraded Component
Speakers, Amplifiers, Subwoofers, TV Surround Sound &
Transom Stereo Remote
Awning, Retractable Electric, SureShade® - Cockpit
Bow Rail, Split
Bow Thruster (V-Drive Only)
Canvas, Cockpit Isenglass Enclosure
Canvas, Dash Cover
Canvas, Mesh Windshield Shades
Carpet Liner, Snap In - Cockpit
Carpet Runners, Interior (Sunbrella®)
Colored Hull (Black, Blue, Horizon or Patina)
Coolbox, Cockpit
Dynamic Running Surface™ (DRS Trim Tab System)
Flagpole w/Base & US Flag
Flooring, Teak - Cockpit & Swim Platform
Flooring, Teak - Optional Extended Swim Platform
Flooring, Teak - Optional Hydraulic Swim Platform
Fuel Transfer Pump - Electric (Diesel Eng Only)
Gourmet Space on Transom Including Grill & Sink (Requires
Optional Ext/Hyd Swim Platform)
Grey Water System

Head, Optional Second Head w/Shower:

Bathroom Tissue Holder, Door Privacy, Flooring Simulated
Teak, Head Enclosed -Full Fiberglass w/Separate Shower
Stall & Shower Door, Mirror Vanity, Power Vent 12V,
Shower Wand w/Vertical Adjustment, Storage, Medicine
Cabinet, Storage Upper Shelves w/Stainless Steel Rails -
Shower Area, Vanity, Sink, Single Lever Faucet & Storage
Below, Opening Portlight

Head, VacuFlush® w/Overboard Discharge (Int'l)

Inverter
Lighting, Underwater - Transom (2)
Macerator w/Seacock Interlock System
Oil Changer System (Optional V-Drives Only)
Passerelle System - Transom
Passerelle System - Transom (Prep Only)
Remote Control, Universal - Logitech Harmony
Rod Holders (2)
Safe
Screen for Sunroom Door
Seating, Salon Sofa w/Pull Out Bed
Seating, Transom (Aft Facing) (N/A w/Gourmet Space)
SiriusXM® Satellite Receiver w/Antenna (N/A Outside N.
America)
Storage Cabinet, Aft Stateroom (in Place of Starboard Bunk)

Sunpad - Cockpit
Sun Shade - Foredeck
Swim Platform, Extended
Swim Platform, Hydraulic, 500 lb Capacity
Table, Hi-Low - Salon
Table, Fiberglass - Cockpit
Table, Matte Teak w/Cover - Cockpit
TV, 24" LED, w/Remote Blu-ray™ Player - Aft Stateroom
Windlass, All-Chain (In Lieu of Std. Rope/Chain)
Windlass Capstan
Windlass - Stern (N/A w/Hydraulic Swim Platform)
Windows, Opening Portlights in Both Staterooms
Windshield w/Opening Side Windows, Manual - Port & Stbd
Wine Cooler/Chiller
Wood Cabinetry, Interior: Prestige Cherry Gloss or Pecan
Woodline Matte

CE Option

NOTE: Some features and options may not be available when a boat is built for regions outside North America and/or has CE Certification. Boats ordered with 220V/50 cycle electrical systems will have the appropriate appliances in the corresponding voltage.

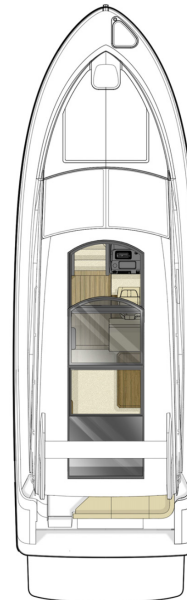

DECK LAYOUT

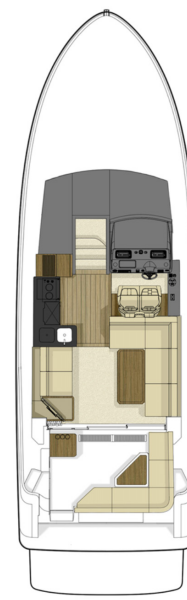

SUNROOM/COCKPIT LAYOUT

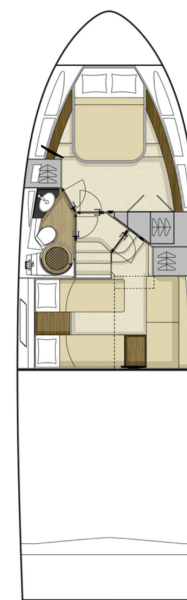

LOWER CABIN LAYOUT
(Standard - One Head)

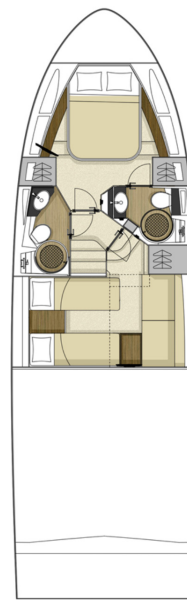

LOWER CABIN LAYOUT
(Optional - Two Heads)

400 SUNDANCER®

Meet the newest design of Sea Ray's Sundancer line: The 400 Sundancer. The generous dimensions of this express-style boat make it exceptionally qualified for cruising and entertaining, and an extensive list of Axis® sterndrives or v-drive inboards, gas or diesel, lets you choose your preferred propulsion. A roomy interior with forward master, big mid-berth, and sunroom sofa can sleep six in comfort. Plus, there's a full galley and head, and a sunroom LED TV with Remote Blu-ray™ Player.



Large windows fill this elegant sunroom with plenty of light. Upgraded amenities include an optional plush sofa that converts to an extra guest bed.



The fully equipped control station features SmartCraft™ diagnostics and VesselView display, plus a Raymarine® e125 widescreen radar/GPS/chartplotter or optional dual displays.



The galley is gourmet-ready, with stainless steel appliances, streamlined solid-surface countertop, fine wood flooring, and plentiful storage.



This handsome forward stateroom includes a double island-style bed w/Visco Elastic foam mattress & drawer storage below.



The convenient aft stateroom includes 3 twin berths with a sliding forward berth that converts to a larger bunk.



This optional gourmet transom space features a solid surface countertop with grill and sink.

ABYC
Sponsor of ABYC Marine
Certification School



Sea Ray



0932015

Sea Ray Boats, 800 South Gay St, Suite 1200, Knoxville, TN 37929. Internet address: <http://www.searay.com>
Note: Not all accessories shown in pictures or described herein are standard equipment or even available as options. Some features and options may not be available when a boat is built for outside North America and/or has CE Certification. Options and features are subject to change without notice. Not all model year boats may contain all the features or meet the specifications described herein. Confirm availability of all accessories and equipment with an authorized Sea Ray dealer prior to purchase. Printed in the U.S.A. September 2015 ©Sea Ray Boats.