



OVERALL LENGTH
W/STD HYDRAULIC
SWIM PLATFORM

51' 1"
15.57 M

BEAM	14' 8" / 4.47 M
DRY WEIGHT	41,423 LB / 18,789 KG
DRAFT	47" / 119 CM
DEADRISE	19°
HOLDING TANK	60 GAL / 227 L

The specification measurements are approximations and subject to variance.



400 GAL
1,514 L



110 GAL
416 L



6 / 7
PEOPLE/OPT

SUNDANCER 510 SIGNATURE FEATURES

- ≈ Limited Edition packed with most popular options as standard equipment
- ≈ Special Edition Crystal Silver Metallic hull side paint accents with painted hardtop
- ≈ Special Beechwood Grey cabinetry with custom Quartz countertops & finishes
- ≈ Zeus® propulsion with helm joystick, Skyhook® station keeper and integrated Autopilot
- ≈ Climate-controlled cockpit sunroom
- ≈ Fiberglass hardtop with pneumatic sunroof
- ≈ Hydraulic Marine Lift Swim Platform with Auto Deploying Stairway
- ≈ Standard Dual Raymarine® Axiom™ 12, 12.1" Color LCD, Radar/GPS/Chartplotter/Fishfinder Combos
- ≈ Bose® Audio System

STANDARD PROPULSION

Twin Cummins QSC 8.3 - 600 T3
Zeus Drives w/DTS
(T-574 hp - 428 kW)

Sea Ray®

LAUNCH INTO LIVING

SUNDANCER 510

Signature

FEATURES & STANDARD EQUIPMENT

HULL & DECK FEATURES

Bottom Paint
Bow Rail, 316 Stainless Steel w/Welded Stanchions,
Intermediate Rails & Life Lines
Cleats, Thru- Bolted - Stainless Steel (8)
Deck Fill Plates, Stainless Steel
Deck Rails, 316 Stainless Steel
Foredeck Sun Lounge with Canvas Cover
Gel Coat:
- Hull - Arctic White
- Deck - Two Tone, Arctic
- Special Edition Crystal Silver Metallic Hull Side Paint
Accents with Painted Hardtop
Handrails, 316 Stainless Steel
Hatch, Deck Vent - Translucent w/Locks & Sky Screen Cover
(Trapezoid)
Hull Windows, Fixed, Smoked Acrylic
Illumined Sea Ray Logos
Lights, Navigation
Lighting, Underwater, Blue - Transom (4)
Portlights, (6)
Rub Rail, PVC w/Stainless-Steel Insert
Signature Badging
Spotlight w/Dual Halogen Bulbs - Remote Controlled (ACR®)
Storage, Transom Wall (For Fenders & Gear)
Stringer System, Fiberglass
Sun Pad w/Adjustable Backrest - Forward Deck
Swim Platform, Hydraulic Marine Lift w/Remote & Manual
Pump and w/ Auto Deploying Stairway - 800 lb Cap
Thru-Hull Fittings, Stainless Steel
Vent System, Engine Room - Integral w/Stainless-Steel
Vents
Windshield, Tempered/Tinted Curved Glass w/Aluminum
Frame and Opening Side Windows - Port & Stbd
Windshield Washer System
Windshield Wipers w/Delay & Speed Control
Yacht Flag & Flagpole

CANVAS (SUNBRELLA®)

Canvas Color - Black
Canvas Cockpit Seat Covers
Canvas Mesh Windshield Shades
Canvas Foredeck Sun Lounge Cover

CERTIFICATIONS:

Meets Applicable USCG & ABYC Standards
NMMA Certification

MOORING SYSTEM:

Anchor, Stainless Steel
Anchor Chute, Stainless Steel
Anchor Rope/Chain Storage w/Gas-Assisted Hatches (2)
Anchor Washdown Spigot w/Hose
Windlass, Rope/Chain w/Foot Switches

COCKPIT FEATURES

Beverage Holders
Door, Transom - Stainless Steel
Grill - Cockpit, Built-In 240V/60
Handrails, 316 Stainless Steel
Hatch, Engine Service - Gas Assisted
Icemaker, 120V - Cockpit
Lighting, Indirect - LED
Outlet, 120V GFI Protected
Seating, U-Shaped Bench w/Storage Below
Ship's Bell
Steps, Boarding (Molded-In)
Speaker Upgrade Package
Sunshade, Retractable, Electric - Aft Cockpit (SureShade®)
(Black Canvas)
Table, Natural Teak w/ Cover
Upholstery, Special Edition Design and Accents (Haze)

SUNROOM FEATURES

Beverage Holders
Door, Stainless Steel Sunroom Entry w/ Tempered/Tinted
Glass (Sliding & Lockable)
Flooring, Wood
Hardtop, Fiberglass w/Pneumatic Retractable Sunroof &
Overhead Lighting
Sunroof Sunshades, Manual - Sunroom
Vent, Manual Hardtop Overhead
Lighting, Indirect LED
Outlet, 12V Accessory
Outlet, 120V GFI Protected
Refrigerator, 120V, Stainless-Steel Drawer Style
Seating, Pivoting Helm (2) w/Armrest, Reclining Backrests,
Teak Footrests, Heavy-Duty Adjustable Pedestals
Table, Wood
TV, 32" LED / Smart w/Remote Blu-ray™ Player on Swing-
Out Bracket for Cockpit Viewing
Wet Bar w/ Sink, Faucet, Quartz Counter Top, Stainless
Steel Handrail, Trash Receptacle, & Storage Cabinet
Bottle Storage

CABIN FEATURES

Carbon Monoxide Monitors
Carpet, 55-Ounce 100% Stainmaster® BCF Nylon w/Dupont®
Advanced Teflon Repel System
Handrails, Stainless Steel
Lighting, 12V Indirect
Lighting, 12V Main - Overhead
Outlet & Switch Plates - Polished Nickel Finish
Outlets, 120V GFI Protected
Outlets, 12V Accessory
Pillows, Accent
Vacuum System, Dyson
Wall Treatment

INTERIOR FINISHES & TREATMENTS:

Wood Cabinetry: Beechwood Grey Veneers with Acrylic
Accents
Special Edition Interior Soft Goods & Finishes
Special Edition Linen Sofa Covering
Window Treatment: Aluminum Blinds
Quartz Counter Tops

SALON (LOWER CABIN):

Entertainment Center
- Bose Soundtouch Audio System with Sirius XM - TV,
40" LED / Smart w/Remote Blu-ray™ Player
- Remote Control, Universal - Logitech Harmon
- USB Port - Powered
- 12V Outlet
Flooring, Wood
Custom Backlit Wall Art
Seating, L-Shaped Sofa w/Pull-Out Bed - Starboard, w/
Storage Below
Steps, Entryway - Aluminum w/ Wood Treads
Storage, Gunwale Cabinets
End Table with Quartz Top
Storage, In-Floor
Powered USB Port

GALLEY:

Coffeemaker, Keurig®
Countertop, Quartz w/Stainless-Steel Sink, Faucet & Sink
Cover
Flooring, Wood
Handrail, Stainless Steel
Microwave/Convection Oven w/Stainless Steel Front - 120V
Power Vent, 12V w/Stainless-Steel Grille
Refrigerator/Freezer, Upright w/Stainless Steel Front - Dual
Voltage 120V/12V
Storage, Drawers w/Cutlery Insert
Storage, Upper & Lower
Stove, Two Burner (Recessed to flush PUPS®) 120V
Trash Receptacle

FORWARD STATEROOM:

Bed, Full-Size Island Style w/Electrically Actuated Extension
& Posturepedic Backrest; Elastic Foam Mattress, Pillows,
Sheets & Coordinated Spread & Drawer Storage Below
Door, Privacy
Flooring, Carpet
Hanging Lockers, Mirrored (2), Cedar Lined w/Lights &
Shelves
Headboard, Lattice Style
Storage, Gunwale Cabinets
Storage, Side Shelves
TV, 24" LED, w/Remote Blu-ray™ Player
USB Port - Powered

FORWARD STATEROOM HEAD / SHOWER:

Door, Access from Salon
Flooring, Tile
Handrails, Stainless Steel
Head, VacuFlush®
Portlight, Opening
Power Vent, 12V
Robe Hook
Shower w/ Seat, Adjustable Wand & Acrylic Door
Storage, Medicine Cabinet - Mirrored
Towel Bar
Towel Cabinet
Towels - Sea Ray
Vanity w/Quartz Countertop, Vessel Sink, Faucet & Storage
Below

MASTER STATEROOM:

Bed, Queen Size w/ Innerspring Mattress, Pillows, Sheets &
Coordinated Spread & Storage Below
Door, Privacy w/Full Length Mirror
Flooring, Carpet
Hanging Locker, Cedar Lined w/Light
Mirror, Wall with SS Accents
Nightstands, w/ Quartz Countertops
Hull Windows - Port & Stbd
Storage, Medicine Cabinet - Mirrored
Storage, Towel Cabinet
TV, 32" LED / Smart w/Remote Blu-ray™ Player
USB Port - Powered
Vanity w/Quartz Countertop, Vessel Sink, Faucet & Storage
Below

MASTER STATEROOM HEAD / SHOWER:

Door, Mirrored w/Access from Mid-Stateroom
Flooring, Tile
Handrails, Stainless Steel
Head, VacuFlush®
Portlight, Opening
Power Vent, 12V
Robe Hook
Shower w/Seat, Adjustable Wand & Acrylic Door
Towel Bar
Towels - Sea Ray

TECHNICAL FEATURES

Air Conditioning / Heating:

- Custom Integral Vent System
 - Zone-Controlled Reverse-Cycle System (32,000 BTU)
Lower Cabin
 - Zone-Controlled Reverse-Cycle System (27,000 BTU)
Upper Sunroom
- Washer / Dryer Combo, 120V

SUNDANCER 510

Signature

CONTROL STATION:

Alarms, High-Water - Bilge, Cabin & Sump
 Battery Parallel Switch - Engines
 Compass
 Dash, Gel Coated
 Horn, Air - (Concealed) Dual Trumpet
 Instrument Panel
 Joystick Control, Zeus®
 SmartCraft® Digital Throttle & Shift (DTS)
 SmartCraft Diagnostics:

- Instrumentation, SmartCraft w/Low-Glare Blue Night Lighting & Chrome Bezels
- 4-in-1 Multigauges (2) (Includes: Fuel Level, Oil Pressure, Voltmeter & Water Temperature)
- Tachometers (2)

SmartCraft VesselView Display:

- Propulsion: Engine Hour Meters, Engine Status, Performance & Fuel, Peak Performance, Boost Pressure (Optional), Troll Control & Cruise Control
- Vessel: Vessel Status, Tank Status, Steering Position & Generator Data
- Environment & Navigation: GPS Interface, Depth & Water Temperature, Depth Alerts, Trip Log Information, Fuel to Waypoint Data & Navigation Data
- Active Alarms/Details
- Alarm History/Details

Steering, Power w/Tilt Wheel

Switch Panel (Backlit)

Switches, Illuminated Weatherproof Rockers & Electronic Dimmer Control

USB Port - Powered

Windshield Defrosters

ELECTRICAL SYSTEMS:

Batteries, 8-D w/Boxes (2)
 Battery Charger/Converter 120V/50 Amp/12V
 Battery Switches, 2-Way Solenoid Activated (MDP & Engine Room)
 Cable TV System w/Inlet, TV Shore Cord, Coax Outlets, Gain Control & Omni Directional Antenna
 Enclosure, Weatherproof Main Solenoid Disconnect w/ Composite Enclosure
 Panel, DC Circuit Breaker - Remote
 Panel, DC Main Breaker
 Panel, Main Distribution - AC
 Shore Power, Cablemaster™ (Glendinning) 240V/50 Amp w/75' Cord & Wireless Remote
 Transformer, Shore Power Isolation - 240V/50 Amp

ELECTRONICS:

Autopilot (Integrated w/Zeus Propulsion)
 Electronics Circuit, 50 Amp/12V
 Raymarine® Dual Axiom™ 12, 12.1" Color LCD, Fishfinder, Radar/GPS Chartplotter w/Integrated 4-kW HD Open Array Scanner
 Skyhook® Station Keeper
 VHF Radio w/Remote Speaker, 8' Fiberglass Antenna & GPS Antenna

ENGINE ROOM:

Bilge Pumps, 12V Automatic (3)
 Bilge Pumps, 12V Automatic High- Water (1 Engine Room, 1 Cabin)
 Blowers, 12V Bilge (2)
 Exhaust, Wet w/ Dual Stage Lift Mufflers
 Fire Suppression System - Automatic w/Manual Pull Gel-Coated Engine Room
 Insulation, Engine Room - 2" w/Loaded Vinyl Barrier
 Ladder, Stainless Steel - Removable
 Lighting, 12V
 Macerator w/Seacock Interlock System
 Oil Changer System - Engines & Generator

FUEL SYSTEM:

Diesel Fuel System - Electric w/Transfer Pump
 Fuel Filters - Remote (Racor®)
 Fuel Lines, USCG - Type A-1
 Fuel Tanks, Aluminum w/Manual Shutoff Valves & Ultrasonic Sending Units

GENERATOR:

11.5 kW Onan® Diesel (120/240V/60 Cycle) w/Sound Shield, Remote Start, Muffler, Freshwater Cooling, Fuel Filter w/ Crossover Fuel, Seacock & Seawater Strainer

UNDERWATER GEAR:

Zeus Drives:
 - Propellers, Stainless Steel
 - Trim Tabs, Hydraulic (Integrated w/Zeus Pod Drives)

WASTE SYSTEM:

Common Drain System
 Head System (VacuFlush®)
 Holding Tank Level Indicators - MDP
 Holding Tank w/Dockside Pump-Out
 Sump Box w/Pump - Automatic

WATER SYSTEM:

Freshwater Washdown Spigots w/Hoses - Transom, Engine Room & Anchor Locker
 Manifold System w/Shutoff Valves
 Pressure Water System w/12V Pump & Charcoal Filtration System
 Shower, Cockpit - Single-Lever Hot & Cold w/Stainless-Steel Door, Braided Hose & Ergonomic Shower Wand
 Water Heater, 240V (11 Gallon)
 Water Inlet, Dockside

STANDARD PROPULSION

TWIN DIESEL ZEUS® DRIVES:

T-Zeus-Cummins QSC 8.3 - 600 T3
 (T-574 hp - 428 kW)

OPTIONS & ACCESSORIES

ELECTRONICS OPTIONS

Raymarine AIS650 Transceiver - Class B

INDIVIDUAL OPTIONS

Canvas, Cockpit Enclosure (Black)
 Canvas, Foredeck Sunshade with Storage Bag (Haze Grey)
 Carpet Runners, Interior (Sunbrella)
 Digital Satellite TV System (KVH TracVision HD7) w/ Receivers For True HD Programming - All Staterooms
 Digital Satellite TV System (KVH TV3) w/ Receivers - All Staterooms
 Flooring, Infinity Seagrass™, Light Tone - Cockpit
 Flooring, Cockpit w/Entry Steps - Teak
 Flooring, Hydraulic Swim Platform - Teak
 Lighting, Underwater, White - Transom (4) (In Lieu of Std Blue)

Ottoman, Salon
 Portlights, Opening - Salon & Galley
 Sunpad Filler Cushions (Table Conversion) - Cockpit
 Table, Coffee (Movable) w/High-Gloss Wood Surface & Storage Below - Interior
 Windlass, All-Chain w/ Galvanized Anchor (In Lieu of Std Rope/Chain)

CE Option

NOTE: Some features and options may not be available when a boat is built for regions outside North America and/or has CE Certification. Boats ordered with 220V/50 cycle electrical systems will have the appropriate appliances in the corresponding voltage.

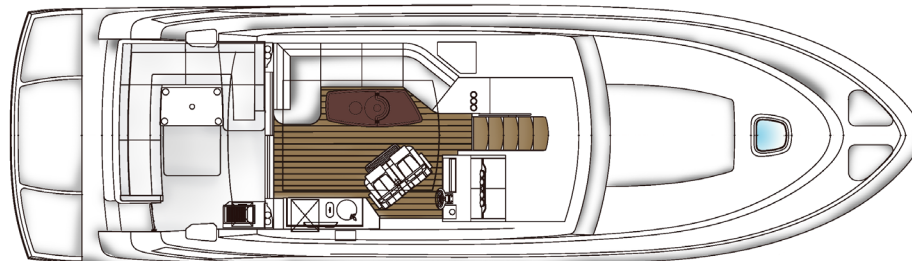

COCKPIT/SUNROOM LAYOUT

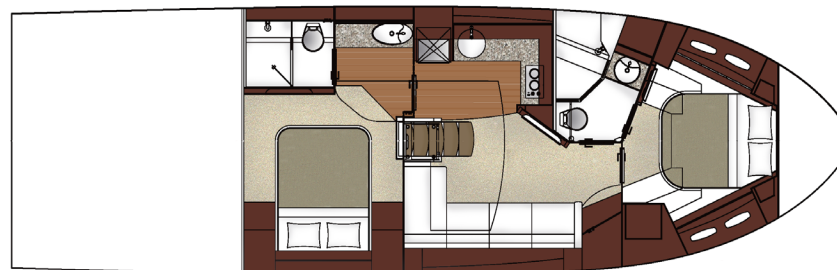

LOWER CABIN LAYOUT

SUNDANCER 510

Signature

Introducing the Sundancer 510 Signature, a limited-run edition of Sea Ray's best-selling Sundancer 510 featuring upgraded materials and select design changes, all geared toward delivering a truly premium yachting experience. Made in America, with characteristic Sea Ray craftsmanship and iconic Sundancer lines, the Sundancer 510 Signature features an enhanced bow lounge sunpad, new wood and Silestone finishes, a large hydraulic swim platform with "Stairway to the Sea" steps, and an exclusive Signature paint scheme. Stellar performance courtesy of the standard upgraded engine package rounds out this unique offering.



12182017

Note: Not all accessories shown in pictures or described herein are standard equipment or even available as options. Some features and options may not be available when a boat is built for outside North America and/or has CE Certification. Options and features are subject to change without notice. Not all model year boats may contain all the features or meet the specifications described herein. Confirm availability of all accessories and equipment with an authorized Sea Ray dealer prior to purchase. Printed in the U.S.A. December 2017 ©Sea Ray Boats.