

FIRST 44 E-BOOK



BENETEAU
AVANT-GARDE IN BOATING

Key Points

Provisional Specifications (* boat in process of certification)

GENERAL SPECIFICATIONS *

• L.O.A (FIRST 44)	14,15 m / 46'5"
• L.O.A (FIRST 44 PERFORMANCE)	14,65 m / 48'1"
• Hull length	13,17m / 43'2"
• L.W.L	12,82 m / 42'1"
• Beam	4,25 m / 13'11"
• Standard draft (Cast iron)	2,15 m / 7'1"
• Standard ballast weight (Cast iron)	3 300 kg / 7,275 lbs
• Performance draft	2,60 m / 8'6"
• Performance ballast weight	3 000 kg / 6,6137 lbs
• Air draft (Aluminum mast)	19,70 m / 64'8"
• Air draft (Carbon mast)	21,32 m / 69'11"
• Light displacement (FIRST 44)	10 660 kg / 23,495 lbs
• Fuel capacity (standard)	200 L / 53 US Gal
• Fresh water capacity	370L / 98 US Gal
• Fresh water capacity (FIRST 44 - option)	200 L / 53 US Gal
• Engine power (Sail drive)	57 CV CR / 57 HP CR

ATTESTATION CE *

• Category A	12 people
with ballast option:	6 people
• Category B	12 people
• Category C	14 people

ARCHITECTS / DESIGNERS

• Naval Architect	Biscontini Yacht Design
• Outside & interior design	Lorenzo Argento

STANDARD SAILS DIMENSIONS (ALUMINUM CLASSICAL MAST)

• Classic mainsail	53 m ² / 570 sq/ft
• Genoa Furler on deck	53 m ² / 570 sq/ft
• Genoa Furler below deck	50 m ² / 539 sq/ft
• Code 0	95 m ² / 1,022 sq/ft
• Asymmetric spinnaker	170 m ² / 1,830 sq/ft
• I	16,80 m / 55'1"
• J with Furler on deck	5,98 m / 19'7"
• J with Furler below deck	5,60 m / 18'4"
• P	16,10 m / 52'10"
• E	5,50 m / 18'1"

CARBON CLASSICAL MAST (+ 1,60m / 5'3")

• Classic mainsail	61 m ² / 657 sq/ft
• Genoa Furler on deck	60 m ² / 646 sq/ft
• Genoa Furler below deck	56 m ² / 603 sq/ft
• Code 0	105 m ² / 1,130 sq/ft
• Asymmetric spinnaker	207 m ² / 2,228 sq/ft
• I	18,50 m / 60'8"
• J with Furler on deck	5,98 m / 19'7"
• J with Furler below deck	5,60 m / 18'4"
• P	17,75 m / 58'3"
• E	5,50 m / 18'1"

FIRST 44: linking 2 worlds



The **FIRST 44** has a very bright, modern and stylish interior, combining white lacquer, moulded wood and top quality upholstery.

Its build and high-spec trims are all carried out in a **dedicated workshop** reflecting and showcasing BENETEAU's expertise. With excellent sea-keeping, the boat is a joy to sail, and yet there are no concessions when it comes to comfort and elegance.

With a scientific approach inherited from the America's Cup, Roberto Biscontini multiplied the simulations and iterations to achieve a **powerful and balanced hull**. This, in addition to a generous sail plan, makes the First 44 a spirited high-performance sailing yacht in all weather.

Well-known in offshore racing, the Mer Forte Design Office offered its **expertise** for this boat, as it did for the Figaro Beneteau 3.

A **full infusion** sailing yacht for which weight control is key

FIRST 44: linking 2 worlds



FIRST 44

The family spirit clearly shows the aim of the First 53, which looks like a Yacht with an easily recognisable, beautiful slender hull designed by Roberto Biscontini.

With the **First 44** destined for cruising fast shorthanded, he has designed a fast, spirited boat that is highly enjoyable on long distances and easily manoeuvrable double-handed.

He has taken things a step further by completely revisiting the deck plan for a model exclusively for racing, similar to the recently unveiled First 36.

This **First 44 Performance** version goes further than simply increasing the sail plan, with features setting it apart and a lighter weight study.

2 version for decidedly different sailing programmes.



FIRST 44 Performance

FIRST 44: linking 2 worlds



The First 44 is imbued with Lorenzo Argento's style: its **interior is modern and stylish**: the lacquered white bulkheads enhance the beauty of the Alpi teak, complementing the soles perfectly, the upholstery is of top quality.

The boat is bright, well-ventilated and with the carefully positioned indirect lighting the interior is still beautiful when night falls

Surroundings that will make you want to stay longer aboard!



Exterior



FIRST 44: a Performance cruiser that offers 2 deck layouts, 2 programs

First 44 positioning according to the version chosen in its competition environment

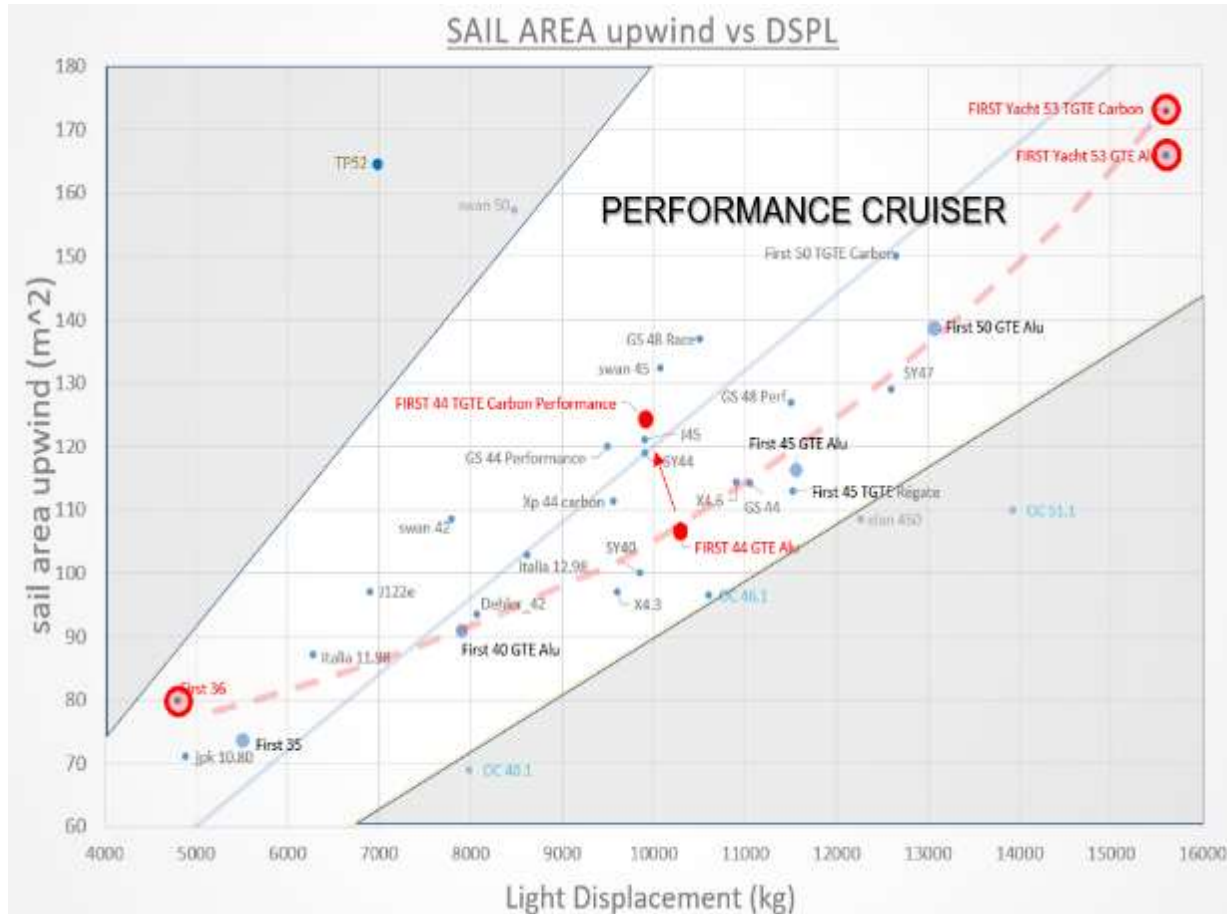

FIRST 44 version : the fast cruiser boat

Mainsail attachment point at bottom of cockpit with alu mast

Mainsail Harken traveller at the back of the cockpit with carbon mast

Protective
central pushpit

Large rope bag in
front of the winches

Genoa tracks on the roof with traveller and hauling
line controlled from the cockpit

Stainless steel handrails, pulpits, stanchions,
lifelines as standard.

With Black Edition Pack: black lacquered
stainless steel + textile lifelines

Manual Genoa furler on the
deck - Facnor Flatdeck.
Manual Genoa furler below
deck as option

Long side
helm seats

Halyard deck covers
for a clean deck

C-strand stainless steel
split backstay with
manual hydraulic piston
to starboard (hydraulic
unit as option)

Winches located near helm station: maneuvers in complete safety in front of each helm station.

2 H46.2 STA manual self-tailing manoeuvre winches (2 electric H50.2 STAEH as option)

2 H50.2 STA manual self-tailing genoa winches (2 manual H60.2 STA or 2 H60.2 STAEH as option)

FIRST 44 version : the fast cruiser boat

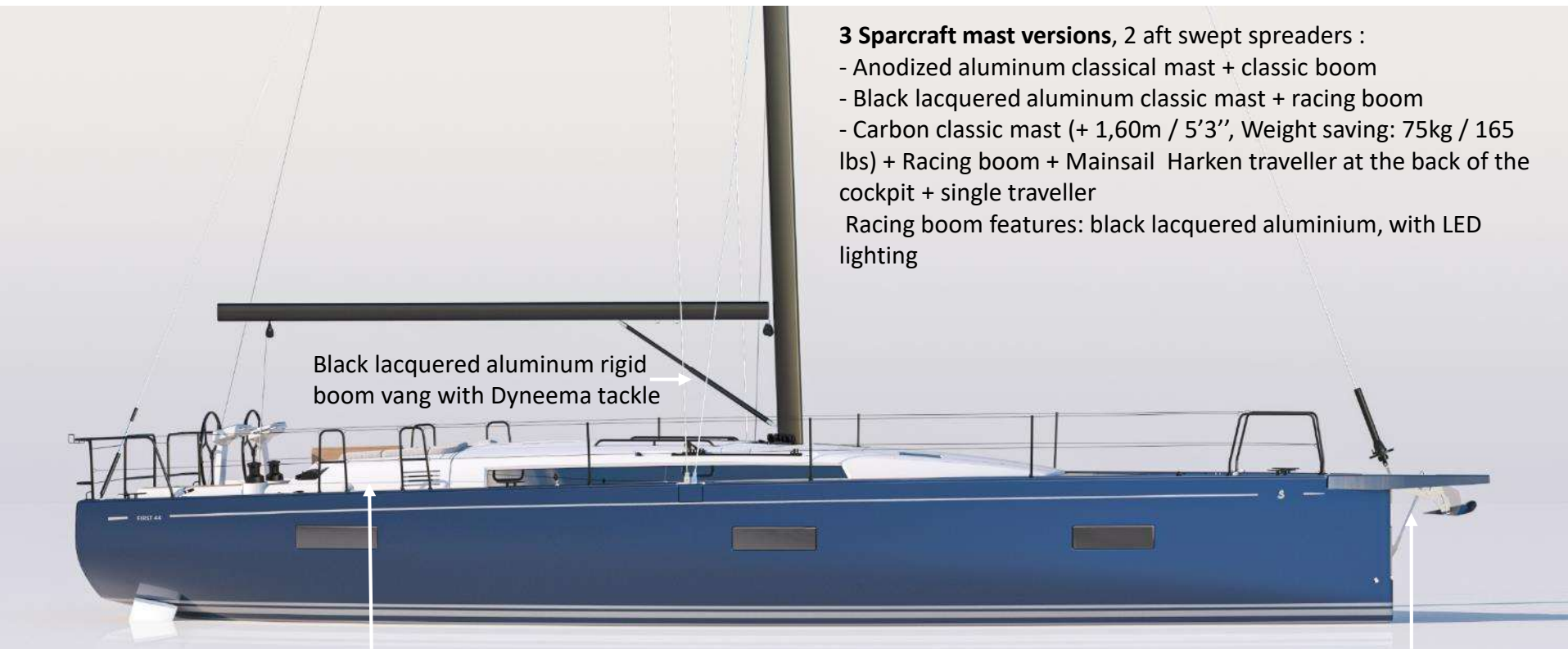
**3 Sparcraft mast versions, 2 aft swept spreaders :**

- Anodized aluminum classical mast + classic boom
- Black lacquered aluminum classic mast + racing boom
- Carbon classic mast (+ 1,60m / 5'3", Weight saving: 75kg / 165 lbs) + Racing boom + Mainsail Harken traveller at the back of the cockpit + single traveller

Racing boom features: black lacquered aluminium, with LED lighting

Black lacquered aluminum rigid boom vang with Dyneema tackle

Twin rudders hung with stainless steel stock

Starboard and Portside side openings as standard

Polyester bowsprit, 1,00m / 3'3" with integrated anchoring gear and bobstay with spinnaker chainplate

FIRST 44 version : the fast cruiser boat

Bright and well-ventilated

2 deck panels in the saloon + large opening of the companionway panel

2 opening portholes in aft cabins: 1 on coachroof, 1 under cockpit bench

2 deck panels in forward cabin , 1 in head compartment

Long coachroof windows with integrated opening porthole

6 hull portholes for a nice sea view in all the living areas

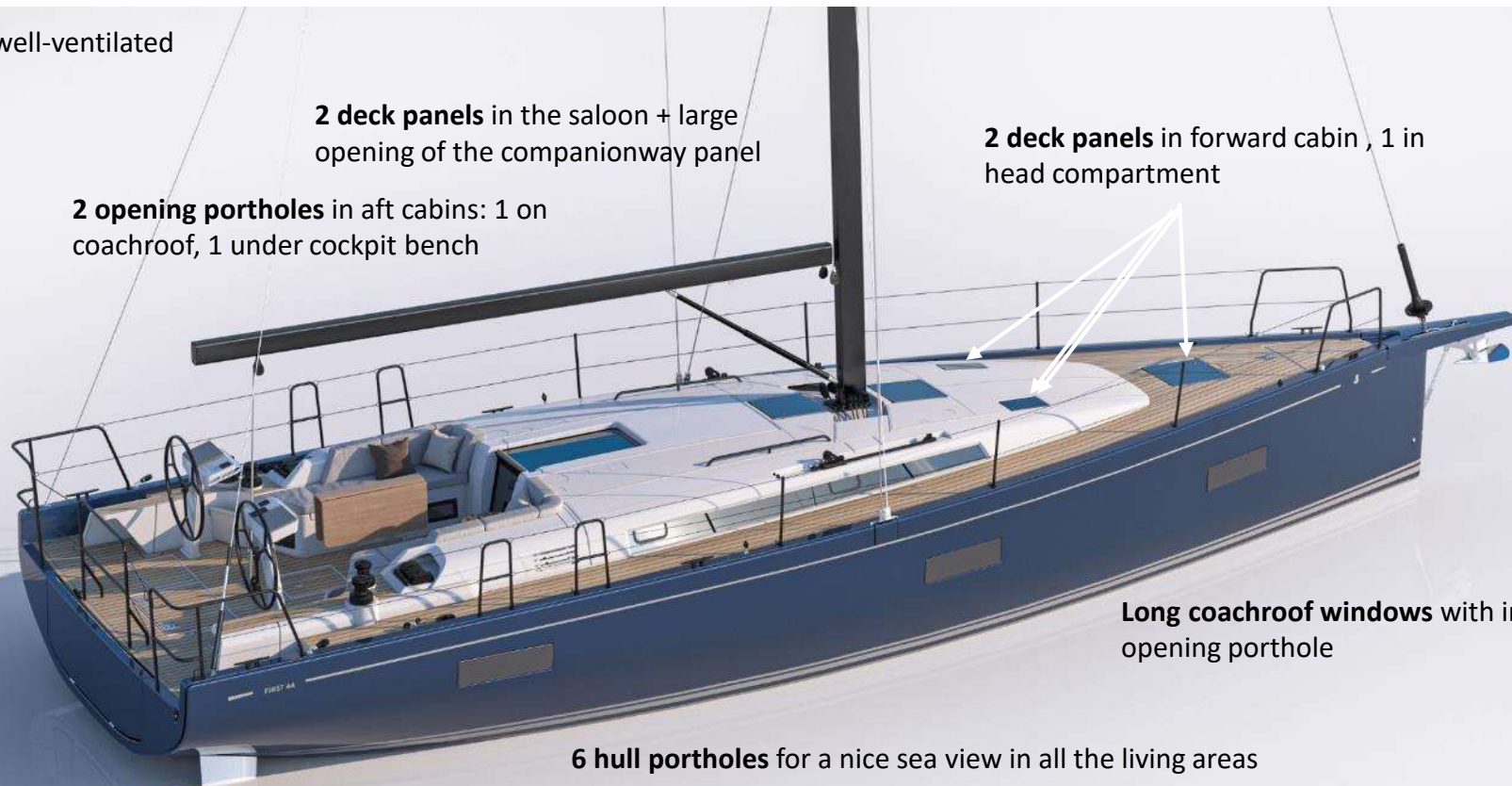

FIRST 44 version : the fast cruiser boat

A true tender garage, a real asset toward the competition Accommodates a fully inflated 2m / 6'7" Highfield Roll-Up tender.
Tender garage also accessible from the cockpit bottom



Nice swim platform (2,32 m x 0,67 m / 7'7" x 2'2") with manual opening. 1 wooden step to easily access to cockpit.

As option: electrically-operated opening with control on helm console

FIRST 44 version : the fast cruiser boat

Cockpit upholstery with backrests available as an option, 2 fabrics to choose from :

Dolce 51

Terry Beige, very appreciate in warm weather

Solid wooden cockpit table

with 2 leafs and 1 central opened storage. Delivered with Charcoal grey cover .
Included in trim level .

Outside Protections: Charcoal Grey Sprayhood, Bimini and Sunshade for the cockpit are available as option .

Black Edition Pack :

6 Black anodised aluminum mooring cleats (Length: 0,40m / 1'4")

Black lacquered stainless steel pulpits, handrails, stanchions

Textile lifelines with side boarding gates



FIRST 44 version : the fast cruiser boat



FIRST 44 version : ergonomic helm consoles with all features at your fingertips

Portside console:



- 12" GPS Map 1223 multi-function touchscreen
- Pilot control
- Compass
- Light control: courtesy, boom, deck projector, spreaders, bimini
(Console fitted with all these controls even if the options are not taken)
- Aft platform opening (option)
- Port water ballast control (option)

Starboard console:



- 12" GPS Map 1223 multi-function touchscreen
- Engine control
- Windlass control with chain counter
- Bow thruster control (option)
- Starboard water ballast control (option)

FIRST 44 version: GARMIN electronic offer

Coastal Pack included in Comfort trim level

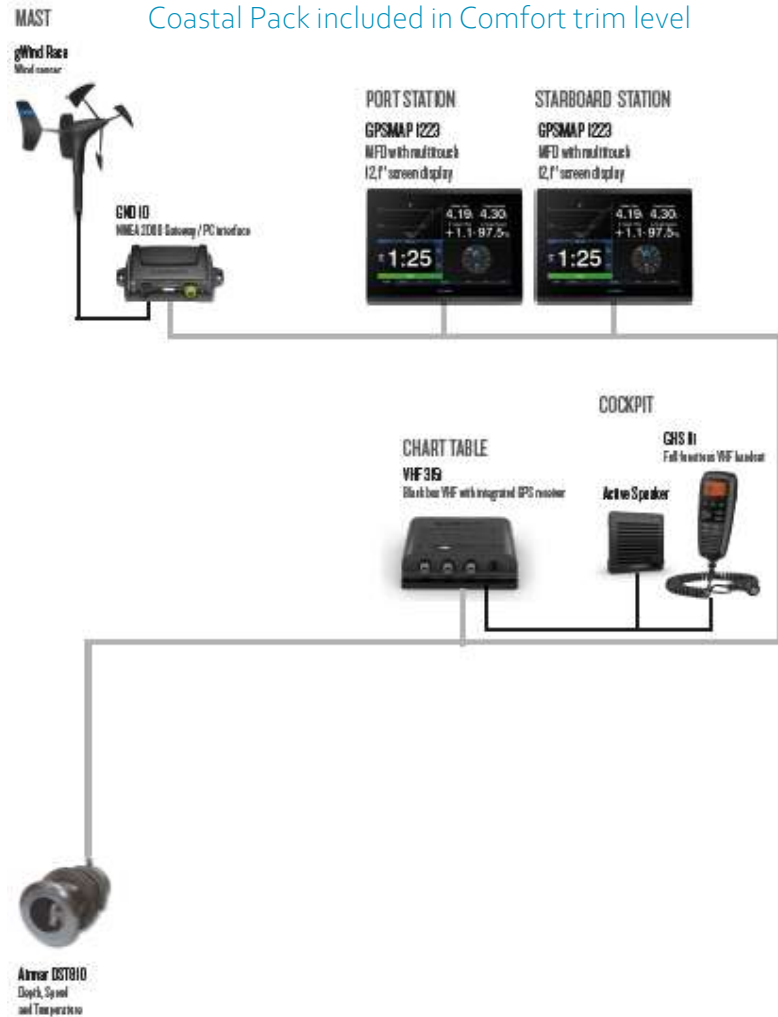

Offshore Pack included in Luxe trim level



FIRST 44 version: GARMIN electronic offer



FIRST 44 version : GARMIN electronic offer

Fastnet Pack offered as option
 Requires Offshore Pack included in Luxe trim level

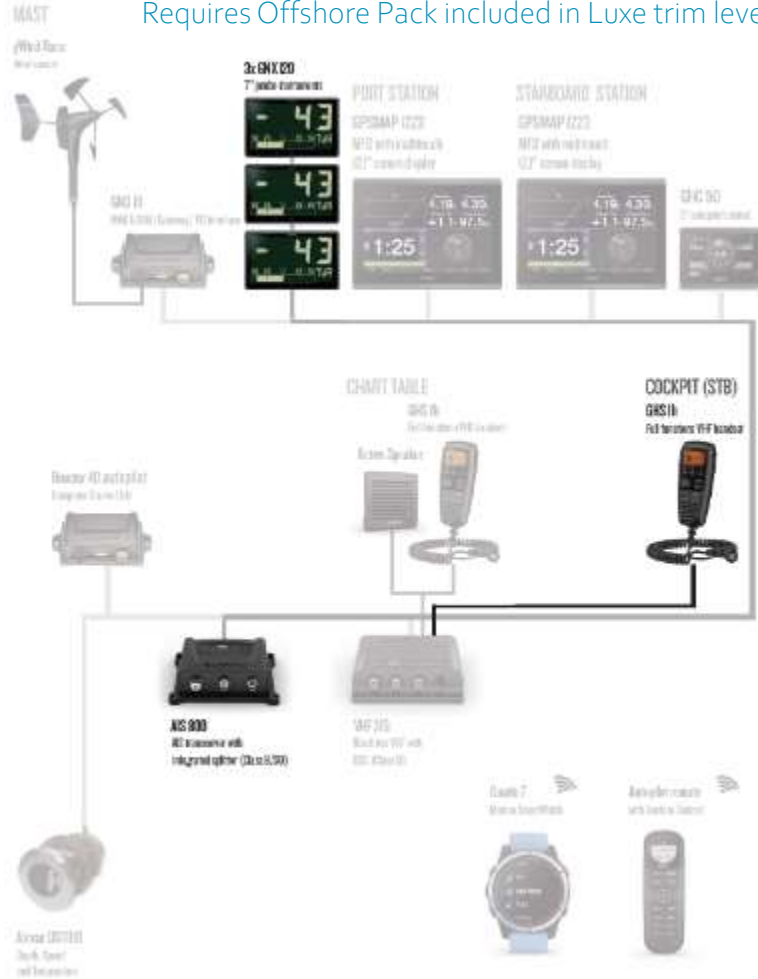

FIRST 44 version : the fast cruiser boat

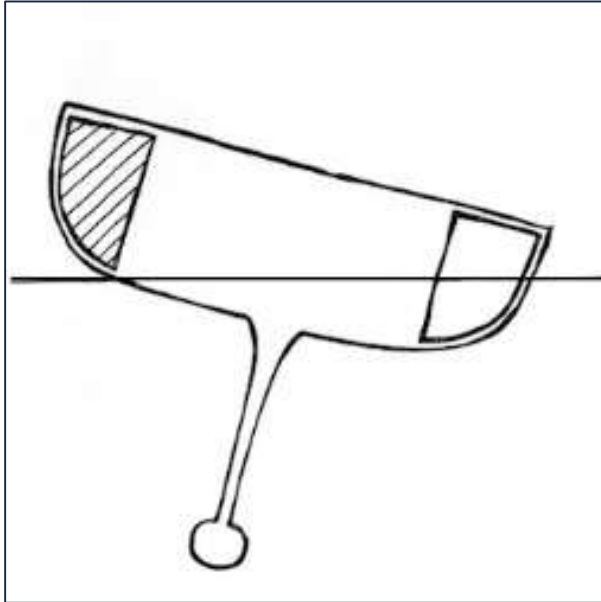

- 350 liters of water each side to sail with limited crew.

- Electric pump to fill and empty the ballasts

Innovative : Ballasts available as option

For what purpose?

Ballasts are rigid tanks containing salt water place in the starboard and aft cabins instead of hanging lockers.

In order to keep storage for the guests, textile storages are added in aft cabins

When **short-handed sailing**, ballasts allow you use the same sail power you would if a full crew was on board.

By acting on the boat's stability, ballasts increase sail stiffness by placing weight windward, so that you can sail safely with more canvas.

This helps hold your course and increases speed.

Filling the ballasts is simple. Using control buttons on the helm console, connected to the electric pumps, you can choose which ballasts you want to fill or empty.

This option is **incompatible with:**

- **First 44 Performance version**, which is for sailing with a full crew.
- Optional diesel forced air heating
- Optional air conditioning for the complete boat (air conditioning in saloon can be ordered)

FIRST 44 version : the fast cruiser boat

Innovative : Ballasts available as option

Textile storage in aft cabins



Control to fill/empty the water ballasts on each helm console



Water ballast location



FIRST 44 PERFORMANCE VERSION: no concessions



FIRST 44 PERFORMANCE VERSION: no concessions

Deck gear completely rethought, rigorous weight study.

This Performance Racer version **for regatta racing and performance cruising with crew** allows 3 mast options and 2 keel options.

The **weight loss** achieved (500 kg with carbon mast options and a very large draught) goes hand in hand with a highly specific rigorous definition throughout the boat:

Specific lightened air conditioning, comfort options deliberately limited, etc., these **drastic choices guarantee strict adherence to the PERFORMANCE version.**

An electronic pack designed in close collaboration with GARMIN to have **the best technology** on board

The standard hull is graced with white hull portholes in all the cabins, with only the central part visible: **the beauty of an transformed hull.**

For people with good taste, the combination of the PERFORMANCE version with the **Black Edition Pack will go without saying!**



FIRST 44 PERFORMANCE VERSION: no concessions

Deck fittings completely revisited for highly accurate trimming:



- 1.50 m/ 4'11" carbon bowsprit
- 6 HARKEN STP winches (Performa line) : 2 H60.2 STP genoa winches on the coachroof, 2 H50.2 STP maneuver winches, 2 H50.2 STP winches with blocks - cleats - jib halyard
- Mainsail Cunningham
- Mainsail Harken traveller at the back of the cockpit
- 2nd genoa halyard
- Harken dual-groove head foil instead of the flat deck furling system
- 8:1 genoa sheet purchase
- DOWNWIND Pack (2 extra halyard lead blocks to starboard, 2 HARKEN Black Magic blocks for the spinnaker/code 0 sheet, 1 HARKEN Black Magic block for the spinnaker tack returning to the dedicated cleat in the cockpit, 1 2:1 Dyneema purchase halyard block for spinnaker or code 0, 1 Dyneema halyard for spinnaker, 1 spinnaker tack with return to dedicated cleat in the cockpit, barber-hauler, short sheet pad eye)
- STAYSAIL Pack (1 starboard halyard lead block, 1 Wichard double pad eye on the foredeck for quick release inner stay, 1 Dyneema purchase halyard block for forestay)
- 4 Harken SpeedGrips

FIRST 44 PERFORMANCE VERSION: no concessions

The ultimate version: every detail is studied to achieve optimum speed.



The PERFORMANCE version hunts for anything in excess, and is lighter in equipment:

- No windlass
- No bow roller
- No helm consoles for better access to the mainsail traveller
- No side access gates
- No teak: cockpit sole, benches, platform with synthetic coating (grey EVA foam coating)
- No courtesy lighting
- No HiFi equipment (Fusion / speakers)
- AGM house batteries replaced by Lithium technology: 1 x 200 Ah battery, weight loss: 110 kg/242 lbs
- 3 lee cloth (aft cabins & saloon sofa)

Sails for the Performance version are not offered in the price list

FIRST 44 PERFORMANCE VERSION: no concessions



Harken twin-groove forestay: to change the headsail without loss of speed and within a short time.
Better safety for the crew: quick maneuvers at the stem

Mainsail Cunningham: to adjust the tension on the luff of the mainsail and control the position of the draft

Without side access openings

Carbon bowsprit
1,50 m / 4'11"

White hull portholes in cabins

Without davit
Without windlass

Showned with Black Edition Pack :

6 Black anodised aluminum mooring cleats (Length: 0,40m / 1'4")

Black lacquered stainless steel pulpits, handrails, stanchions

Textile lifelines remain

FIRST 44 PERFORMANCE VERSION: no concessions



6 Harken Performa manual winches:

2 H50.2 STP Harken Performa manual maneuver winches on the roof for halyards + 3 clutches on port and starboard

2 H60.2 STP genoa sheet winches behind cockpit benches

2 H50.2 STP Harken Performa manual maneuver winches with blocks - cleats - jib halyard (for mainsail sheet, adjustment genoa traveller - staysail sheet- boom vang - mainsail tack + 1&2 reef - and for spinnaker tack - barber hauler Electric as option

Without helm console for a better access to mainsail traveller

Mainsail traveller at cockpit bottom

FIRST 44 PERFORMANCE VERSION: no concessions

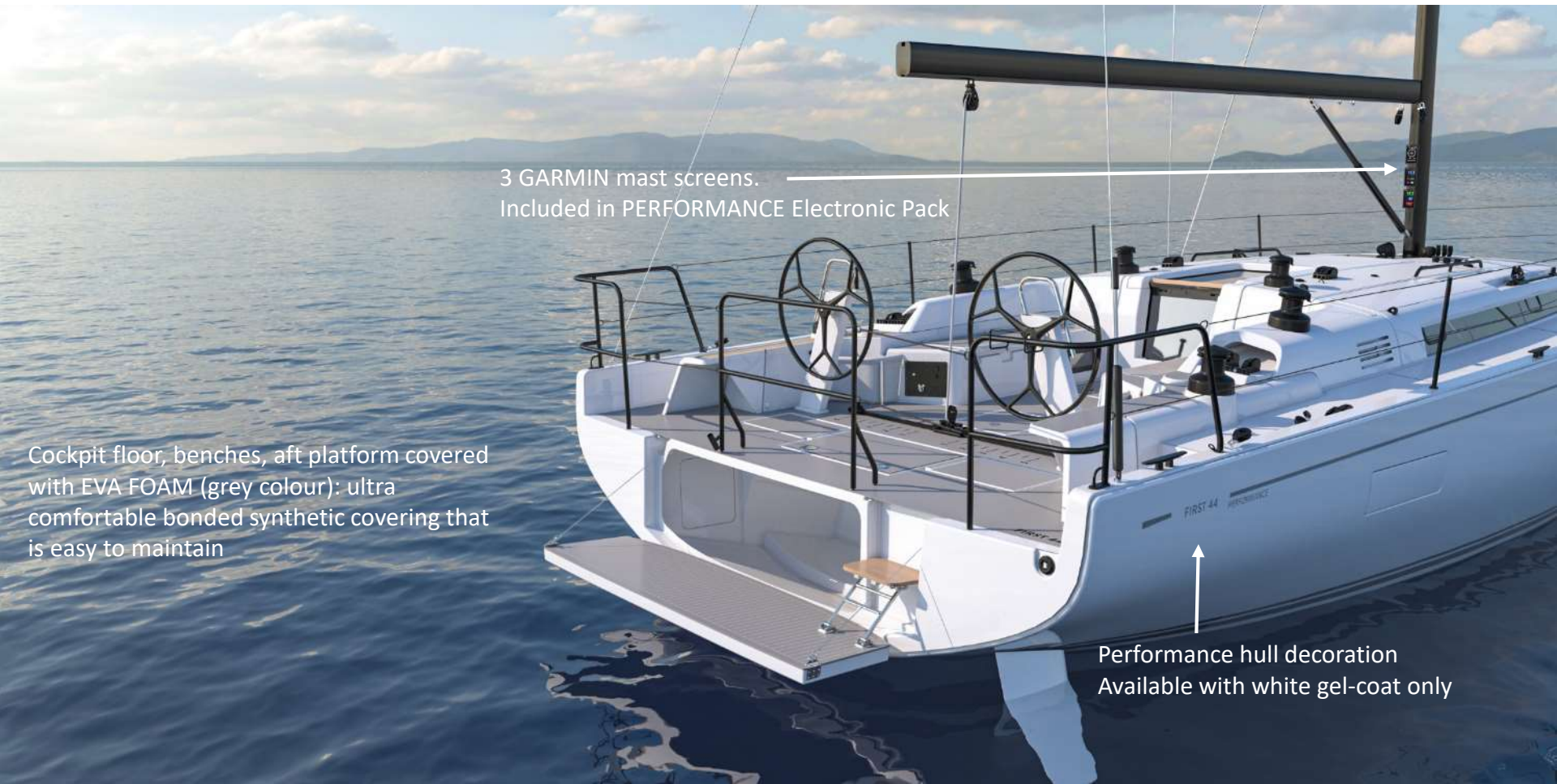

3 GARMIN mast screens.
Included in PERFORMANCE Electronic Pack

Cockpit floor, benches, aft platform covered with EVA FOAM (grey colour): ultra comfortable bonded synthetic covering that is easy to maintain

Performance hull decoration
Available with white gel-coat only

FIRST 44 PERFORMANCE VERSION: GARMIN electronic offer

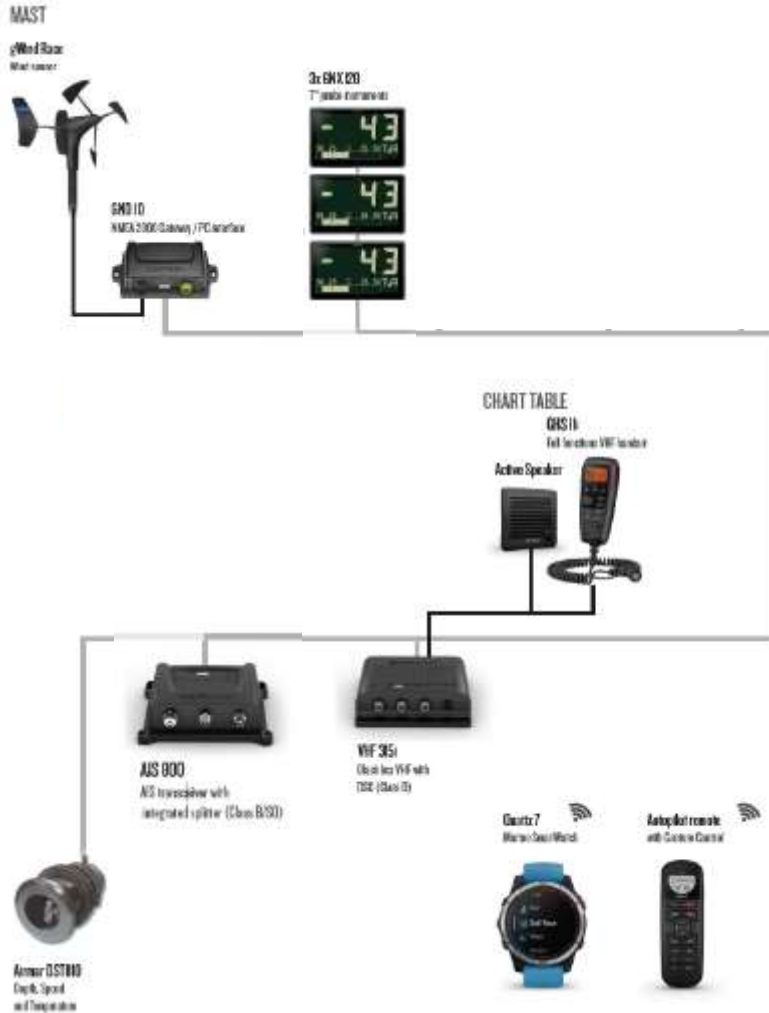

GARMIN Performance Electronic Pack*:

- 3 GNX120 7" mast screens + mast bracket + cover
- AIS 800
- Garmin Quatix 7 connected watch
- Wind Sensor gWind Race - pole 1 m/3'3": Windvane, Anemometer
- PC interface (GND10)
- Airmar DST810 sensor (Log, Speedometer, Temperature)
- Fixed 315i VHF at chart table, without AIS receiver function
- GHS11 VHF Wired handset at starboard helm station
- Windex Windvane
- Protective covers for steering wheels (Charcoal Grey)

*: First 44 Performance version: no helm consoles

FIRST 44 PERFORMANCE VERSION : Limited choice for the optional equipments to guarantee the- ideal weight

OPTIONS COMPATIBLE WITH FIRST 44 PERFORMANCE:

- Garmin Performance Pack
- Black Edition Pack
- Anodized aluminum classical mast + classic boom
- Black lacquered aluminum classic mast + racing boom
- Carbon classic mast + Racing boom
- Performance keel
- Harken hydraulic unit
- 2 Harken Performa (H60.2 STPEH) electric manoeuvre winches STPEH)
- White composite steering wheels
- Outboard engine bracket
- Polyester folding gangway
- Electric inflator/deflator
- Shore fresh water supply
- Carbon flagstaff
- Retractable bow thruster
- 3 burners Gas cooker
- Berth in saloon
- Interior upholstery: Fabrics, Leather, Nubuck, Ultraleather
- Air conditioning 16 000 BTU in saloon and forward cabin
- Air conditioning 16 000 BTU in saloon and forward cabin + Pre- fitting in aft cabins

OPTIONS NOT COMPATIBLE WITH FIRST 44 PERFORMANCE:

- Comfort and Luxe trim level
- Coastal / Offshore / Fastnet Packs + Garmin separate options
- Downwind Pack
- Self-tacking rigging Pack
- Self-tacking staysail rigging Pack
- Sails Packs and sails options
- Mooring Pack
- Manual genoa furler below deck
- Outside cockpit upholstery
- Water ballasts
- Pearl-grey gel-coat
- Hull paint
- LED lighting of spreaders
- Electrically opening bathing platform
- Sprayhood
- Bimini
- Cockpit sunshade
- Additional fresh water tanks
- Seawater electric pump in galley
- Spring mattress in the owner's cabin
- 2 000 VA inverter
- TECMA electric fresh water/sea water WC in the owner's head
- Quiet Flush fresh water/seawater electric WC in the aft starboard head

The background is a solid blue color with several large, overlapping, semi-transparent circular shapes in a lighter shade of blue. These shapes are positioned in the top-left and bottom-right corners, creating a sense of depth and movement.

Interior

A seductive interior



A seductive interior



The **extremely comfortable sofa** will be popular for relaxing. It faces the **saloon with a widthways table** designed for dinners with up to 6 guests. Its layout in relation to the mast makes **circulation** between the galley and the owner cabin easier and enhances the feeling of **space**. These 2 spaces have a wonderful **view of the sea**.

L-shaped galley near the companionway, designed so you can have a good time at sea and for long trips aboard: adapted ergonomics, large areas of space, good refrigeration capacity.

The **large chart table to port** also functions as a pleasant desk space.

The exclusive owner space is along similar lines: lots of woodwork, beautiful ensuite shower room with a spacious shower cubicle. Bright, well-ventilated, central bed with easy access to both sides, large hanging locker. Designed for comfort.

The guest spaces are just as attractive and your guests will love them



A seductive interior



Transversal saloon in front of the galley: an intimate space which allows a free circulation toward forward.

190L / 50 US Gal icebox, with top and front opening

Corian Glacier White work top with moulded Apli teak beading

Stainless steel 2 burner gas hob / oven with grill on gimbal mounting(19 L) . Optional 3 burners + Tempered glass cover on the top

A seductive interior



A seductive interior



A seductive interior



1 hublot ouvrant dans le vitrage d'hiloire tribord

Chart table near companionway
Easy access to 12V electric panel
located in the high storage

Very comfortable sofa, soft
welcome. Length: 1,83m / 6'
Storage under seat

A seductive interior



Focus on galley: ergonomics and storage



Optional 3 gas
burners with
tempered glass
cover

Focus on galley: ergonomics and storage



Focus on galley: ergonomics and storage



Focus on chart table

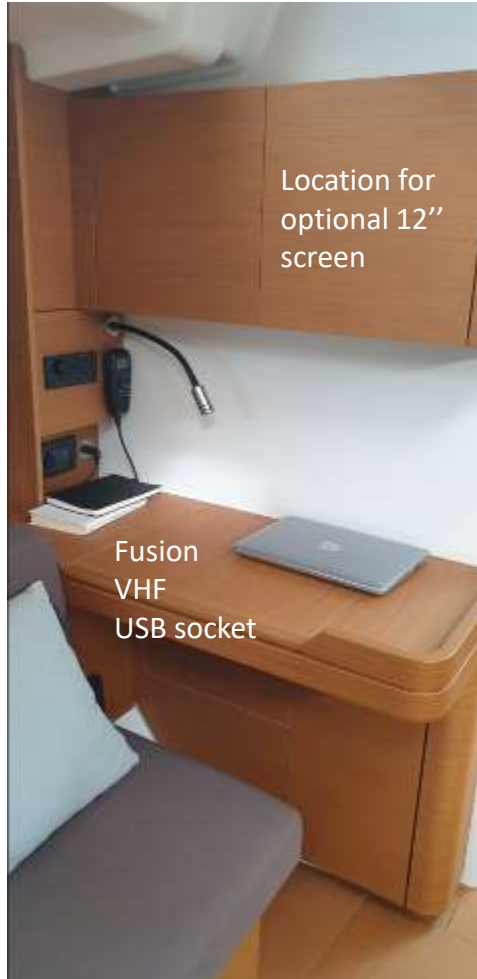

Owner's cabin: a premium layout



Owner's cabin: a premium layout

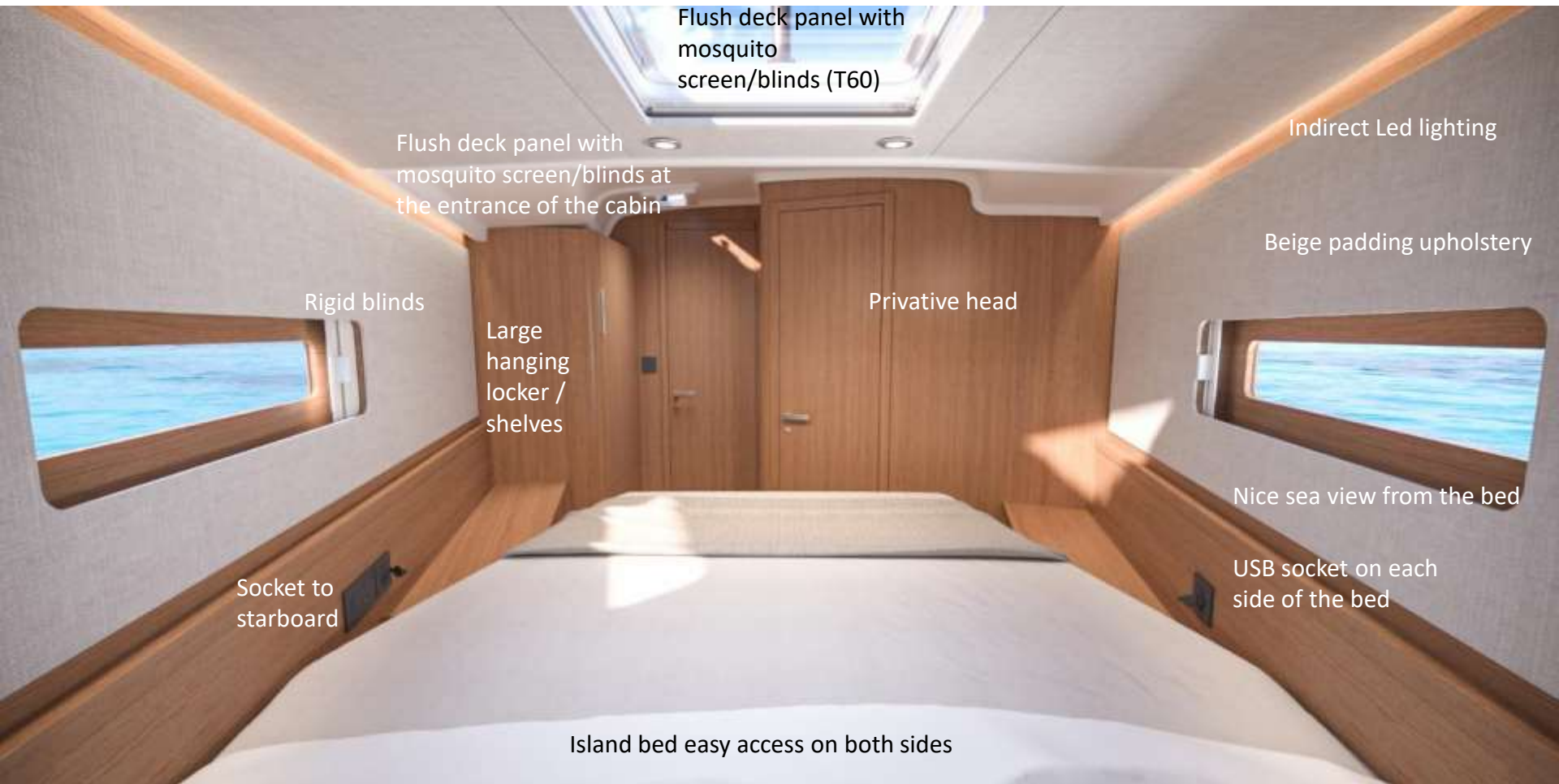

Flush deck panel with mosquito screen/blinds (T60)

Flush deck panel with mosquito screen/blinds at the entrance of the cabin

Indirect Led lighting

Beige padding upholstery

Rigid blinds

Private head

Large hanging locker / shelves

Nice sea view from the bed

Socket to starboard

USB socket on each side of the bed

Island bed easy access on both sides

Owner's cabin: a premium layout



Owner's cabin: a premium layout



Owner's privative head compartment





Hull porthole with rigid screen

Beige padding upholstery along hull

Storage along the hull

Nice headroom above the bed: very comfortable

Wardrobe + shelves

Double berth, 1,38m width

Guest cabins

2 very long opening portholes with pleated blind for a well ventilated cabin



Guests head compartment

To starboard down the companionway

Large shower area with translucent rigid screen

Long glazing covered with film for privacy, opening porthole.

Bright and well ventilated

Corian worktop

High storage

Mirror



The background is a solid blue color with several large, overlapping, semi-transparent circular shapes in a lighter shade of blue. These shapes are positioned in the top-left and bottom-right corners, creating a sense of depth and movement. The word "Ambiance" is centered in the middle of the page in a white, sans-serif font.

Ambiance

Upholstery – Protections

44

Exterior upholstery	Cockpit seats and backrests	Terry Beige	✓
		Dolce 51	✓
Outside protections	Sprayhood	Charcoal Grey	✓
	Cockpit bimini		✓
	Cockpit Sunshade		✓

Hull colour

44

Hull colour	White gel coat + hull decorated in metallic grey (RAL 9016)	✓
	Pearl grey gel coat + hull decorated in white (RAL 7004)	✓
	Hull and deck: Light paint + hull decorated in metallic grey or dark paint + hull decorated in pearl white	✓

Gel-coat



Pearl Grey

Covers – Lazy Bag

44

Covers	Cockpit table	Charcoal Grey	✓
	Wheels		✓
Lazy Bag			✓



Terry Beige

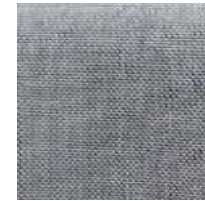

Dolce 51



Charcoal Grey

Hull Paint



! Pearl grey gel-coat and hull paint not available for First 44 Performance

Outdoor ambiance

Terry Beige Outside upholstery



Indoor ambiance

INTERIOR UPHOLSTERY

44

Interior upholstery	Lounge Falcon 162	✓
	Lounge Greige 160	✓
	Lounge Mega Rabbit 160	✓
Covering on handrails	Leather Brown DK02	✓

44

Leather / Cuir	DK 45 (Taupe)	✓
Nubuck	LG 13 (chocolat)	✓
Ultraleather	Pelican 291-5676	✓
	Stone 291-3602	✓

✓ = standard ✓ = option



Lounge Falcon 162 Standard



Lounge Greige 160



Lounge Méga Rabbit 160

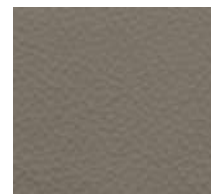

DK 45 (taupe)

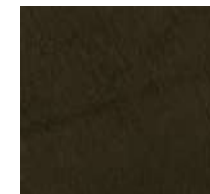

LG 13 (chocolat)



Pelican 291-5676

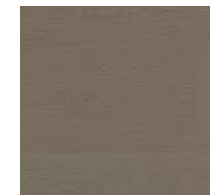

Stone 291-3602

Indoor ambiance

Wood & Floors : Teak alpi + Teak Alpikord floors



Lounge Méga Rabbit 160 upholstery

Teak Alpikord floors

Teak alpi

Indoor ambiance

Wood & Floor / Bois & planchers: Teak alpi + Teak Alpikord floors



Lounge Falcon 162 upholstery

Offered layout

3 cabins 2 heads



Exterior Dimensions

Outside dimensions

Aft platform :
2,32 m x 0,67 m / 7'7" x 2'2"

Cockpit table
Folded dimension 0,92 m x 0,29 m / 3' x 11"
Opened width: 1,02m x 0,92 / 3'4" x 3'

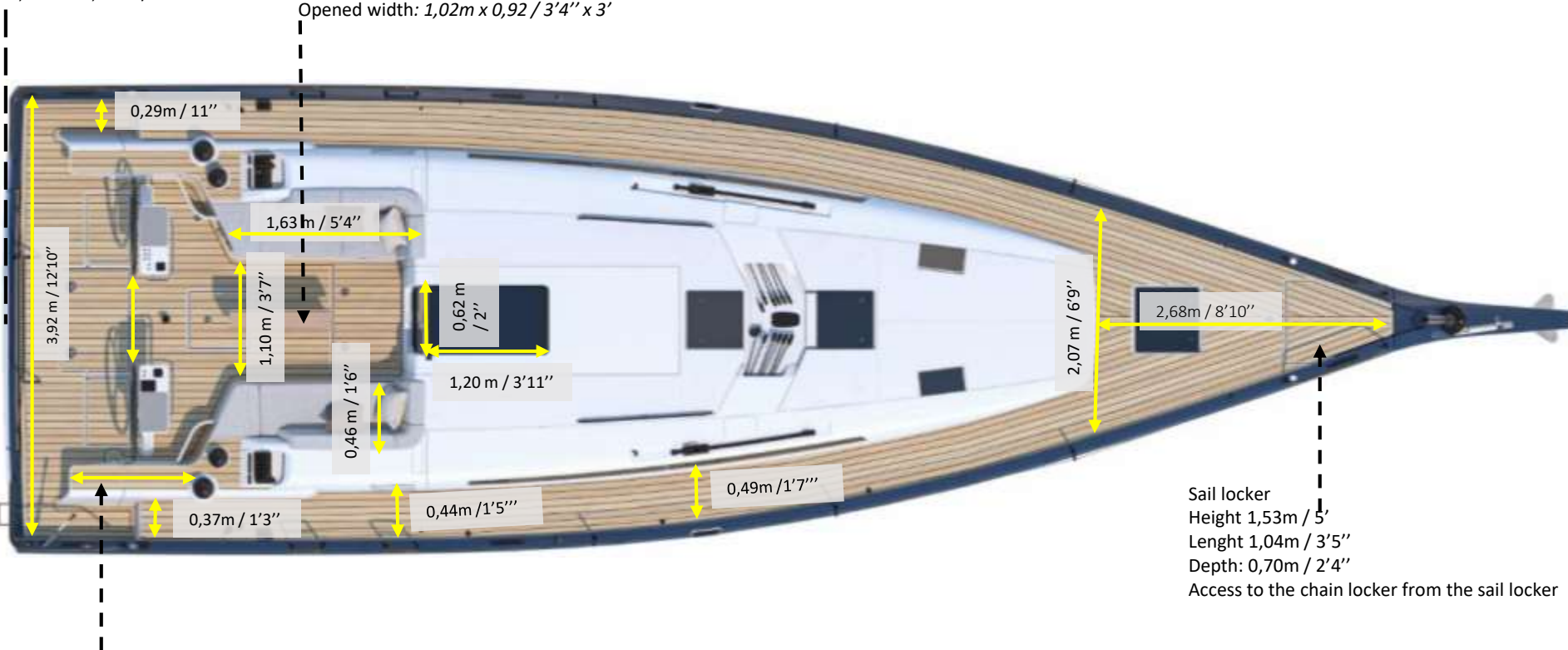

Helm seat:
1,00 x 0,25 / 3'3" x 10"

Interior dimensions & headrooms

Interior dimensions

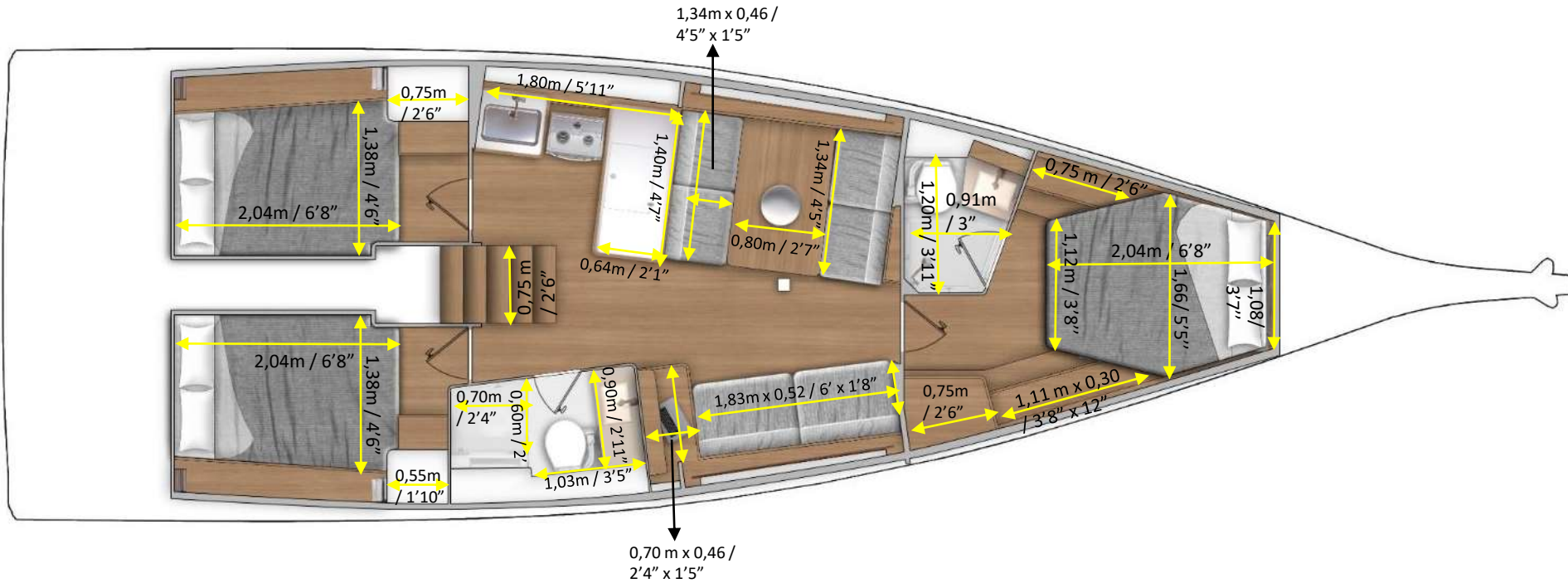

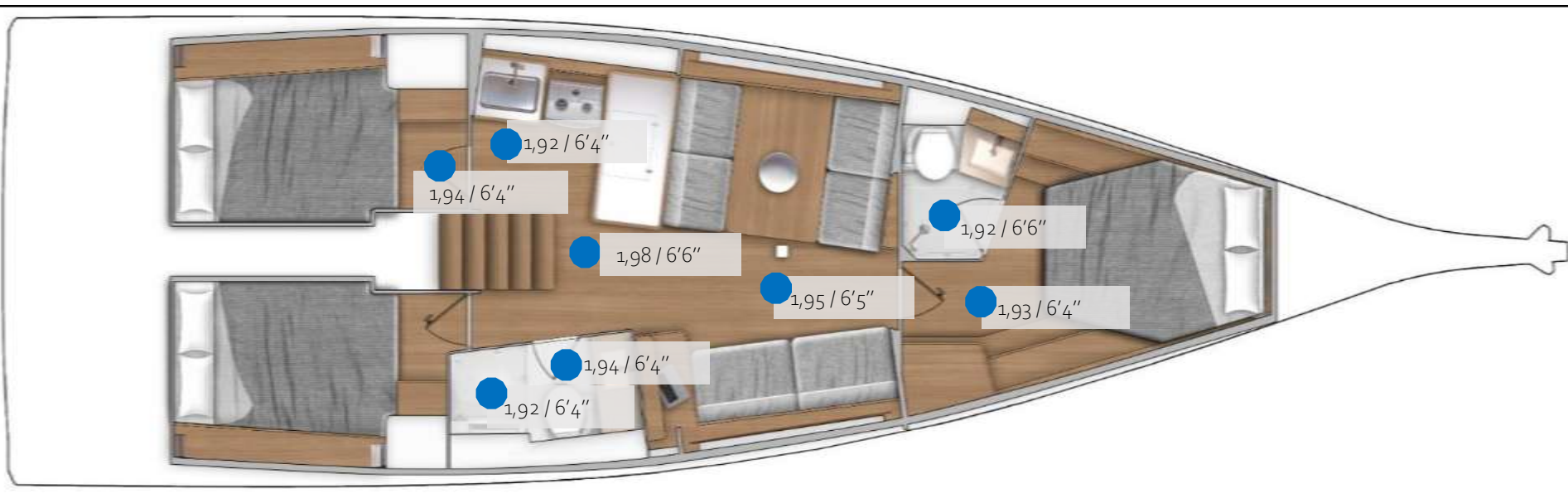

Technical equipments location

Technical equipments location

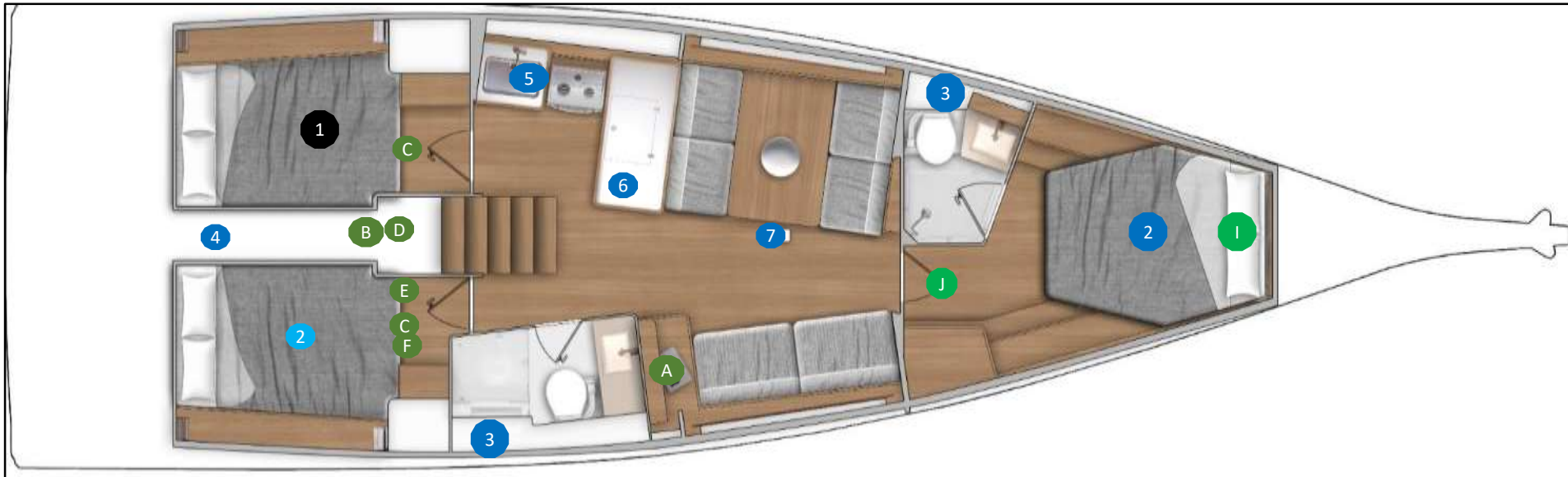

- 1 Fuel tank 200 L / 53 US Gal - standard
- 2 Fresh water tank 330L / 87 US Gal- standard F44
- 2 Fresh water tank 200L / 53 US Gal- standard F44 Perf
- 3 Holding tank 64 L / 17 US Gal - standard
- 4 Water heater 40 L / 11 US Gal- standard
- 5 Plumbing board (accumulator tank- water units)
- 6 Accumulator tank- Water units
- 7 Bilge pump

- A Electrical panel
- B 2 000 VA 12 V – 230 V Inverter *option*
- C 2 x 2 AGM service batteries -(100 Ah) - standard and *trim level* (Lithium battery for First 44 Performance)
- D Battery charger (40 Ah) - standard
- E 1 AGM engine battery (50 Ah) - standard
- F Battery switch

- I Bow thruster-12V - *option*
- J Sensor *option*

Air conditioning in the saloon and the forward cabin + pre-fitting in aft cabins



1

Pre-fitting for 8 000 BTU unit in aft cabins. (unit bloc not fitted)



Air conditioning outlet



Thermostat

2

Air conditioning unit 16 000 BTU
Saloon and forward cabin

Air conditioning in the saloon and the forward cabin

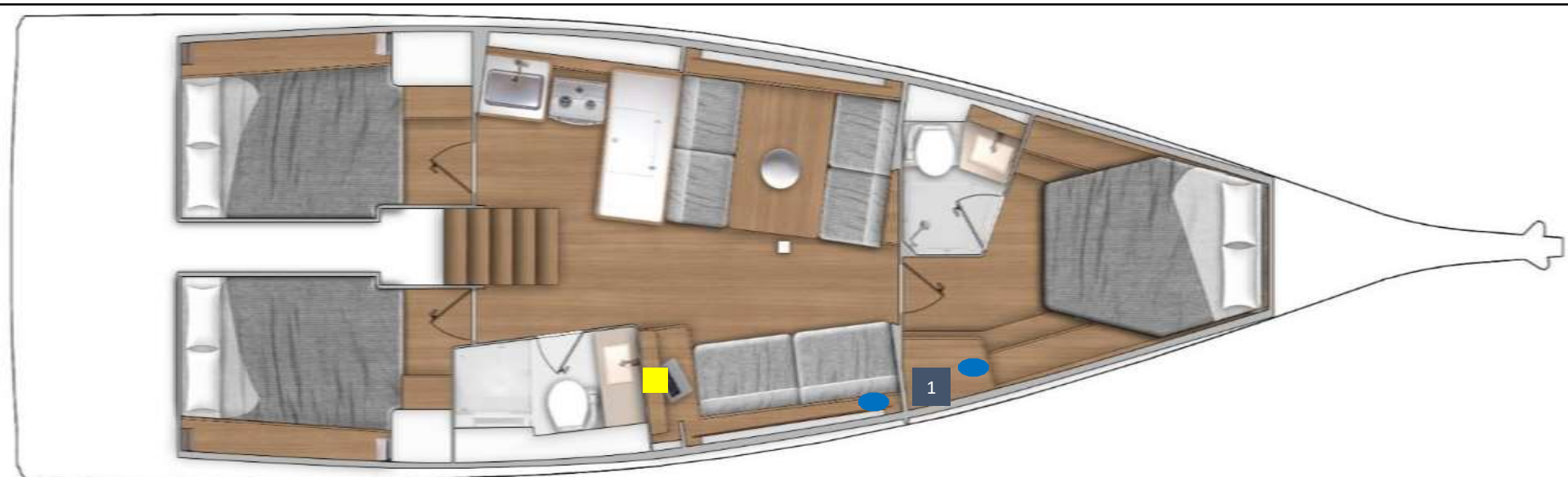

1

Air conditioning unit 16 000 BTU
Saloon and forward cabin



Air conditioning outlet



Thermostat

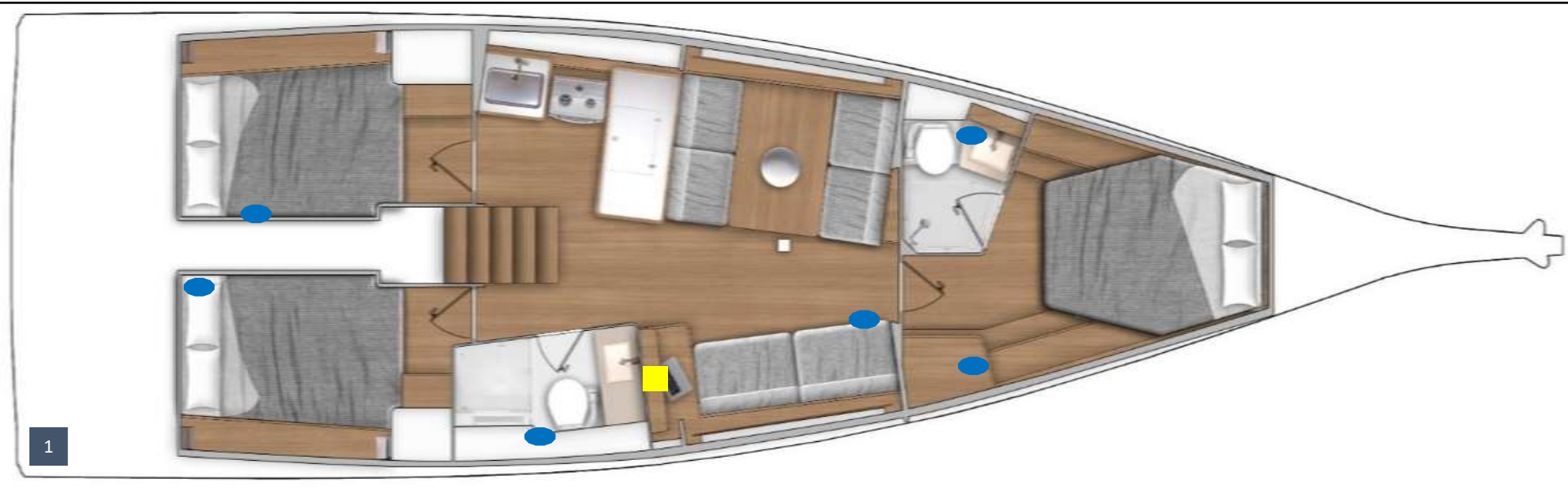

1





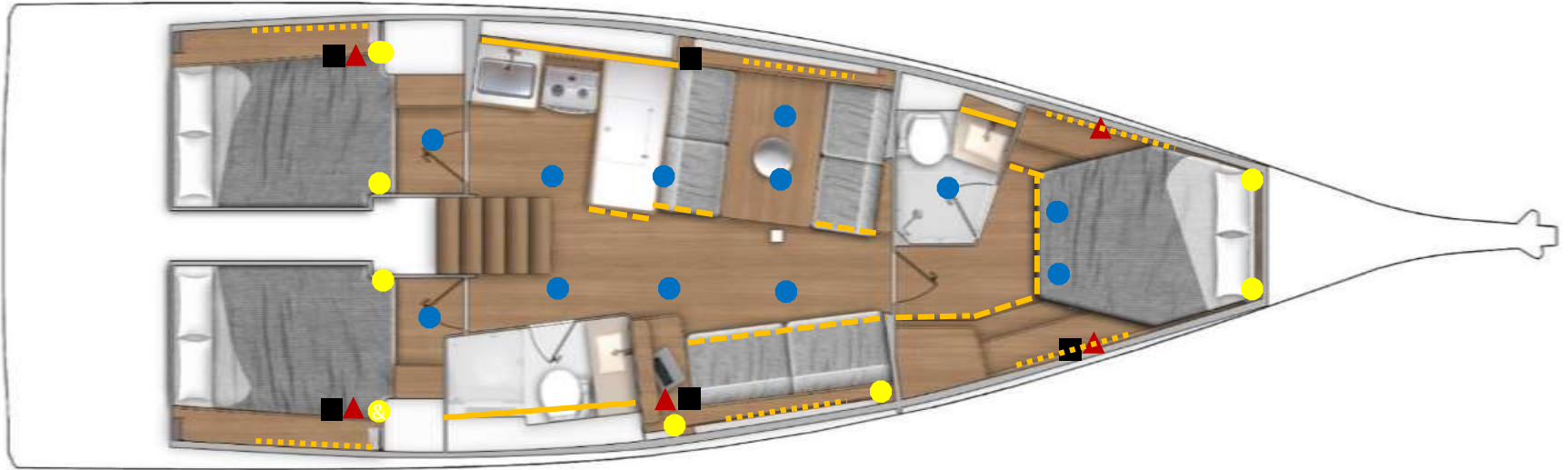

1 E Boiler - 5 500W -

 Hot air outlet

 Thermostat

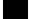
Lighting
Sockets
USB sockets



- | | | | |
|---|------------------------------|---|----------------|
|  | LED strip (High) |  | USB socket |
|  | LED strip (Low) |  | 230V socket |
|  | LED strip (inside furniture) |  | Reading light |
| | |  | Overhead light |