

OCEANIS 37.1

E-BOOK



BENETEAU
AVANT-GARDE IN BOATING

Key Points

Oceanis 37.1

E -BOOK



7th generation of Oceanis cruisers now complete!



Strong markers reinforced:

Easy

A standard dedicated to easy manoeuvring: standard mast, self-tacking jib, 1 winch on the coachroof.

Comfort

We have studied the well-being of everyone aboard in minute detail: natural light, sea views, long seating, storage space, good headroom, large lengthwise galley... for a unique experience on board

Spaces

The stepped hull creates a large living area, with an instantly noticeable feeling of space.

Large cockpit with room for everyone and a large swimming platform

Performance: the First Line version, standard mast, upgraded deck hardware, square-top mainsail: for greater sensations and fun at the helm

Carbon-free sailing with an electric engine especially for inland waterways



Specifications

GENERAL SPECIFICATIONS *

• L.O.A:	11,93m 39'2"
• Hull length	10,99m 36'1"
• L.W.L.	10,83m 35'6"
• Beam	3,92m 12'10"
• Deep draft (Cast iron)	2,10m 6'11"
• Deep ballast weight	1 800kg 3,967 lbs
• Shallow draft (Cast iron)	1,63m 5'4"
• Shallow ballast weight	1 970kg 4,342 lbs
• Air draft (all masts), with aerial	16,60m 54'6"
• Light displacement	6 864kg 15,128 lbs
• Fuel capacity (standard)	130L 34 US Gal
• Fresh water capacity	355L 94 US Gal
• Engine power	40 HP 40 HP

ARCHITECTS / DESIGNERS

• Naval Architect:	Marc Lombard
• Outside & interior design:	Nauta Design

EC CERTIFICATION *

• Category A	- 8 people
• Category B	- 10 people
• Category C	- 10 people

STANDARD SAILS DIMENSIONS *

• Classic mainsail (standard)	37,00m ² 398 sq ft
• Furling mainsail (Option)	31,00m ² 333 sq ft
• Self-tacking jib (standard)	23,00m ² 248 sq ft
• Furling genoa (110 %)	30,00m ² 323 sq ft
• Code 0	53,00m ² 570 sq ft
• Asymmetric spinnaker	95,00m ² 1,022 sq ft
• Classical mast	
- I	13,51m 44'4"
- J	4,33m 14'2"
- P	13,75m 45'1"
- E	4,50m 14'9"
• Roller furling mast	
- I	13,43m 44'1"
- J	4,33m 14'2"
- P	13,90m 45'7"
- E	4,80m 15'9"

PERFORMANCE SAILS

- Square top mainsail	42,50m ² 458 sq ft
- Genoa (on Flatdeck furler)	31,00m ² 334 sq ft

* Provisional specifications, boat in process of certification.

Oceanis 37.1

E-BOOK



An agile and seamlessly adaptable cruiser



Standard version with Comfort finish:

Very easy to manoeuvre: 1 winch on the coachroof, self-tacking jib

Very easy to maintain

Great modularity to suit a wide range of programmes

Upwind/downwind pack: winches, stemhead, genoa: greater sail area, ideal for cruising

Deluxe cockpit table, Dolce 51 upholstery: a cockpit with everything you need to have a good time

Aft cabin windows

Side access gates

Helm console

Iro-Deck cockpit floor

An easy sailing standard combined with a remarkable amount of space

Relaxed family sailing with as little manoeuvring as possible: standard mast with angled boom for easy sail storage, self-tacking jib for easy tacking, 1 single winch on the port side of the coachroof – cruising within everyone's reach!

This simplicity is combined with spacious accommodation that offers everyone a high level of comfort.

The steps along the entire length of the hull optimise the volume of the cockpit while emphasising the slender silhouette.

Spacious helm stations:

The elimination of the backstay frees up the helm station, and along with the 65cm-long lifting seats, result in visible improvements to comfort and ergonomics.

Large cockpit:

The 2 long bench seats, which are wider near the companionway, provide ample seating capacity, while the cockpit's great width makes moving around easy. A high platform closes off the cockpit at the stern, so that the space is well protected and safe.

A large access to the sea: thanks to the width of the cockpit and the lifting helm seats, you have a very wide passageway to the swim platform at anchor.

Its size is similar to the Oceanis 40.1, making it a real advantage!



Vast swim platform
2.69 m x 0.77 m / 8'10" x 2'6"

Oceanis 37.1

E-BOOK



An Easy sailing standard

No backstay = a very comfortable helmsman's area .

Lift-up helm seats for very wide access to the platform at anchor (trim level).

A reassuring cockpit well closed with the height of the platform

Standard table: 2 GRP flaps, stainless steel structure with handrail function

1 H35.2 maneuvering winch on the port side

Angulated boom for easy storage of the classic mainsail

Classic mast with 2 spreaders
Without backstay
Optional furling mast

Rigid boom vang with tackle

6 opening deck hatches T44 and T10: bright and well-ventilated interior

Mainsail bridle on the roof

Self-tacking rail

Single davit.
Bowsprit in Rigging Pack

Open pulpit

Twin rudders = more responsive helm, better control, increased safety

Long stainless steel handrails for safe moves

Chined hull over the entire length of the hull: highlights the slender silhouette, optimizes volumes



An agile and seamlessly adaptable cruiser

Customised comfort:

Cockpit upholstery, sprayhood, bimini, deluxe cockpit table, side access gates, extra hatches for the aft cabins, Iro-deck cockpit floor, etc. The cruiser can be transformed to cater to the preferences and requirements of each individual user.

Customised sail plan:

2 different packs are available to improve speed and sensations at the helm and to satisfy customer expectations: Upwind/Downwind Pack and First Line Pack.

Both have 3 extra winches, 2 of which are close to the helm station, as well as a stemhead to add headsails ideal for light air.

In terms of sail area, the self-tacking jib has been replaced by a genoa with the Upwind/Downwind pack (+ 7 m² sail area).

With the First Line pack, the sails are optional and the cut of the square-top mainsail as well as the flatdeck furling genoa deliver an upwind sail area of 73.50 m², increasing the sail area by 13 m² compared to the standard version.

An electronic pack helm console:

For enhanced reading of the navigation display and a more comfortable helm position



An agile and seamlessly adaptable cruiser

2 Winches manuels d'écoute de génois
H40.2 STA aux postes de barre

Starboard helm
console with 7"
screen included in
Coastal Pack

Self-tacking jib track kept when genoa is
chosen. Traveller and sheet are removed.
Instead: genoa track on the roof

Polyester bowsprit
with integrated
anchoring gear and
bobstay. Chainplate
for Spi or Code 0
included in rigging
pack. Mooring kit as
option

1 Winch manuel de manoeuvre sur le
roof tribord H35.2 STA



Oceanis 37.1

E-BOOK



An agile and seamlessly adaptable cruiser : the comfort options



Additional opening portholes in the aft cabins. Option

Dolce 51 cockpit upholstery. Option

Iro-Deck cockpit floor. Option

Optional side openings

Luxe cockpit table with wooden flaps - Option
Included in Family trim level with GRP flaps

Alu First Line Pack: to make the most of the hull's potential



Fast

A **deck hardware upgrade** for the most demanding sailors.

With this upgrade, the boat can be fitted with Performance sails: **22.50%** more surface area compared to the standard version.

ALU FIRST LINE PACK (In blue, the equipment that differentiates it from the other Rigging Packs)

Requires standard classical mast

! Boast supplied without sail - Performance sails optional

- Polyester bowsprit with integrated anchoring gear and bobstay
- Flatdeck genoa furler
- Additional jammers:
 - 1 Single clutch, on starboard roof
 - 2 Double jammers, in coaming (1 to port, 1 to starboard)
- Dyneema Performance running rigging

- Genoa sheet tracks on roof with traveller (pulls back the traveller on the self-trimming jib rail)
- Asymmetrical spinnaker rigging / Code 0
- German system (Dyneema core two-way mainsail sheet at the helm station)
- 1 Starboard manual (H35.2 STA) rigging winch + Cadet Grey halyard bag
- 2 Manual (H40.2 STA) genoa sheet winches + Aluminum "Speed Grip" winch handle + Winch handle box
- Performance hull decoration (Red sticker)

To be combined with the Elvström Performance Sails Pack

Dacron C-breeze high tenacity :

Square-topped mainsail 42,50 m² / 458 sq / ft (full batten , 4 battens)

Genoa 31,00 m² / 334 sq / ft

Raymarine Electronic Packs

Coastal Pack :

- 1 i70s display, at port side helm station
- DST810 Sensor (Log, Speedometer, Temperature)
- Wind Sensor (Windvane, Anemometer)
- Windex Windvane



Offshore Pack :

= Coastal Pack

+

- Starboard helmstation:
 - 1 Steering console
 - 1 7" Axiom + multi-function touchscreen
 - 1 Console cover, Cadet Grey
- P70s autopilot + control (to port)
- Chart table: RAY73 VHF, AIS receiver function



Oceanis 37.1

E-BOOK

Large platform, fixed bathing ladder,
intermediate step

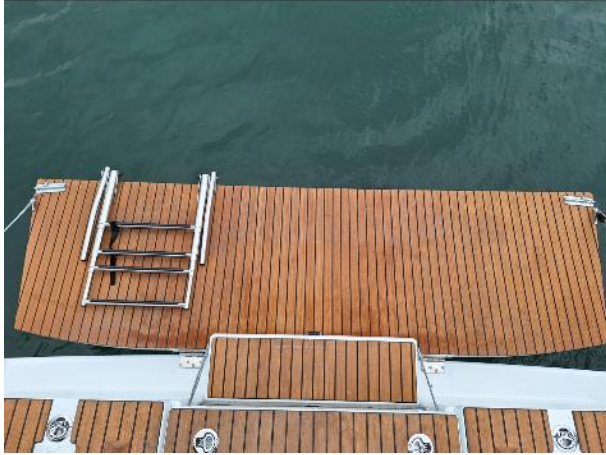

Iro-deck cockpit floor



Lift-up helmsman seat



Genoa tracks on the coachroof (Rigging pack)



Anchor locker. Electric windlass (optional)



Companionway door



Oceanis 37.1

E-BOOK

Available options

Dolce 51 cockpit upholstery



Luxe cockpit table



Cadet Grey cover for Luxe cockpit table



Oceanis 37.1

E-BOOK

Available options

Side openings



Electric winch on the port side



Additional opening portholes in the aft cabins



Oceanis 37.1

E-BOOK

Some pictures of the available sails options

First Line: Square-topped mainsail

Code 0

Lazy bag & Lazy jacks



Oceanis 37.1

E-BOOK

Interiors: Spaces and Comfort



Interiors: Spaces and Comfort

Spaces and Comfort:

A real feeling of space thanks to the hull shape, pushing the boundaries of the interior!

A very spacious starboard saloon seating 6 people faces a long galley to starboard.

Both the owner's and guests' cabins are comfortable, and the 3-cabin 2-shower room version even means that the owner can have an **ensuite shower room**, which is unusual on a cruiser this size.

On the 2-cabin version, you can opt for an **extra-large shower cubicle** in the starboard aft shower room.

Carefully studied ergonomics, a selection of upholstery, large berths, light, ventilation and headroom all contribute to a **premium lifestyle on board!**

A large storage locker at the bottom of the companionway is ideal for cruising.

Interiors with lots of advantages, enhanced by very harmonious surroundings crafted by Nauta Design.



Interiors: saloon, galley



3 opening deck hatches and long coaming glazing: good ventilation and a bright boat that is pleasant to live in

Bookcase by the chart table

Location for TV pre-wiring

Beautiful sea views from the saloon and galley

6 people comfortably seated in the saloon

Central seat fixed to the floor. Can be slid under the table
Ample storage space in the locker

Unobstructed access to the fore cabin and galley at all times

Interiors: saloon, galley



Numerous high shelves on both sides of the hull

Optional porthole blinds

Beige padding upholstery
in saloon as standard

Standard Neo
05 upholstery

Double berth option: mattress
and small legs for the table

Large, bright, long kitchen with sea view

Head compartment
access

Oceanis 37.1

E-BOOK

Interiors: saloon, galley

Huge U-shaped saloon with standard central seat in the 3-cabin version
(possibility of adding it as an option in the 2-cabin version)



Large long galley on starboard side



Interiors: focus on galley



Oceanis 37.1

E-BOOK

Interiors: focus on galley



Interiors: chart table area

Large chart table: long top-opening (65cm / 2'2"), open shelves nearby

Huge storage at the bottom of the companionway



Interiors: TV pre-fitting in the saloon

Size and location:

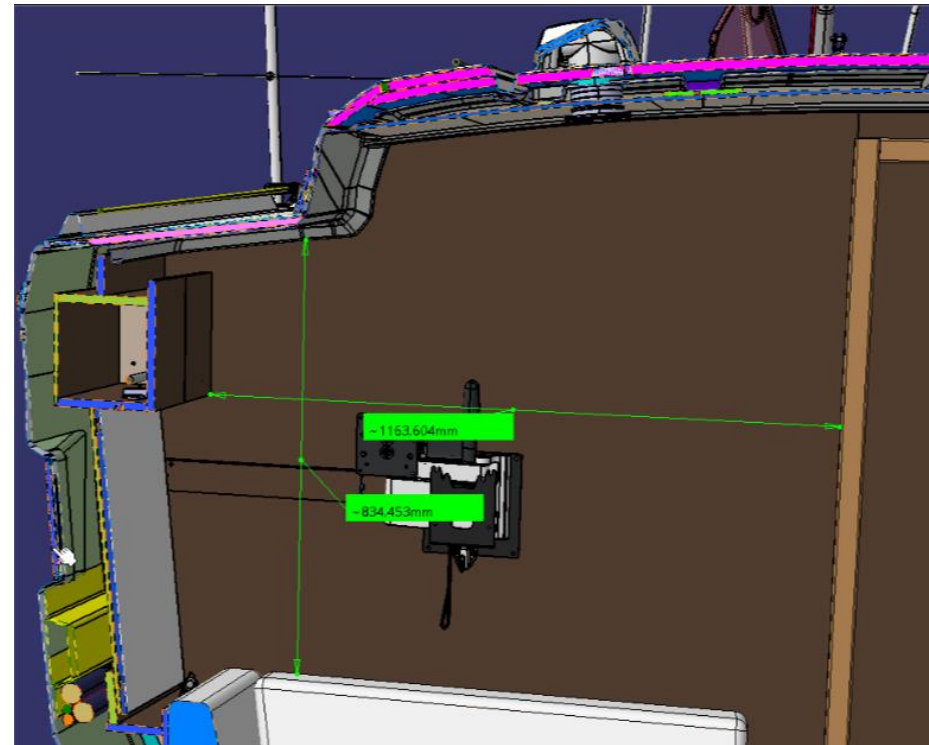

Interiors: Owner's cabin



A large attractive space for the owner:

The cabin is bathed in natural light and very well ventilated with its 3 deck hatches.

The large double bed offers a very good sleep:
2.07 m x 1.61 m x 0.90 m / 6'9" x 5'3" x 2'11"

2 hanging lockers on either side of the hull

Indirect lighting under the overhead shelves creating a very pleasant atmosphere

Bed head with open storage, direct lighting and USB socket for recharging mobile devices

Beige padded lining along the hull with a Comfort trim

Interiors: a premium owner's-cabin version

3-cabin version with 2 shower rooms with a very comfortable layout

An ideal layout that preserves the owner's privacy

The hull design allows a private shower room to be integrated on the port side of the cabin without affecting the size of the double berth (2.10 m x 1.38 m / 6'11" x 4'6').

The shower room has a washbasin, 1 wall unit with mirror, 1 mixer tap with shower attachment and a manual toilet. T10 deck hatch ventilation



Interiors: Guest cabin(s)

Workshop version



Large shower option



1 aft cabin version:

Ideal for people who enjoy long cruises, it provides space for a workshop on the starboard side, easy to get to from the saloon, and a huge sail locker.

On the port side, the bed is now bigger offering a king-size berth (2.00 m x 1.82 m / 6'7" x 6').

In this version, you can also choose a [spacious shower space seamlessly integrated into the starboard aft washroom](#), instead of the standard workshop setup. The shower features a wooden seat for the same level of comfort as a Yacht. Removable rail for drying all-weather gear

Interiors: Guest cabin(s)

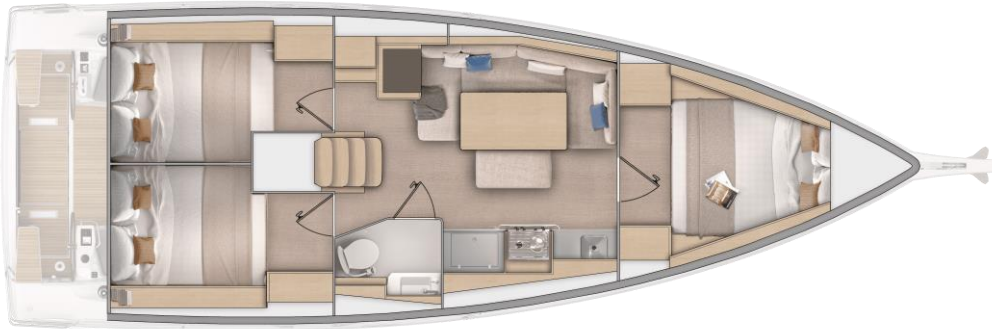

2 aft cabins version:

Workshop and sail locker replaced by a second aft starboard cabin

These 2 symmetrical cabins provide comfortable sleeping quarters for guests:
2.00 x 1.50 m / 6'7" x 4'11"

Indirect lighting, wardrobe, good headroom, guests are made to feel very welcome



Offered layouts

Oceanis 37.1

E-BOOK

2C1H



2C1H
+
Large shower
area



3C1H



3C2H



The background is a solid blue color with several large, overlapping, semi-transparent curved shapes in a lighter shade of blue, creating a modern, abstract design. The shapes are primarily located in the top-left and bottom-right corners.

Focus on Iro-Deck

Oceanis 37.1

Focus Iro-Deck: Glued-laminated Iroko deck cladding



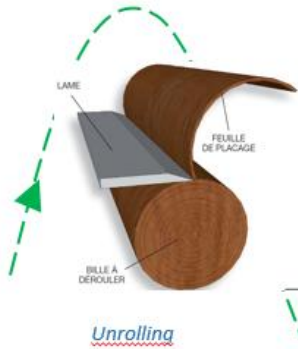

GABON



15/10

Thin sheets of Iroko are glued together (as for Alpi)

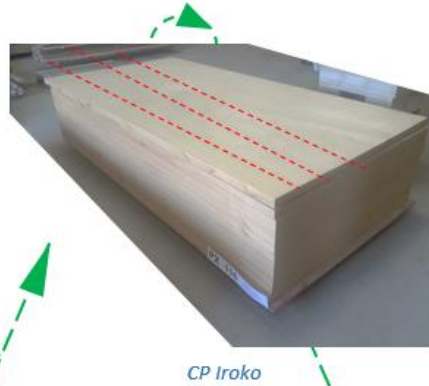

The resulting block is then cut along its width to obtain planks.

The result of this process is that the planks are stable in colour. The wood does not rot, the boards are splinter-free and will not split.



Lame

Shock resistance



Structure ✓



Singularities of the wood ✓

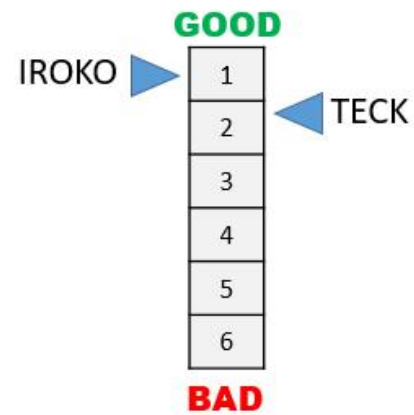

Non-slip surface

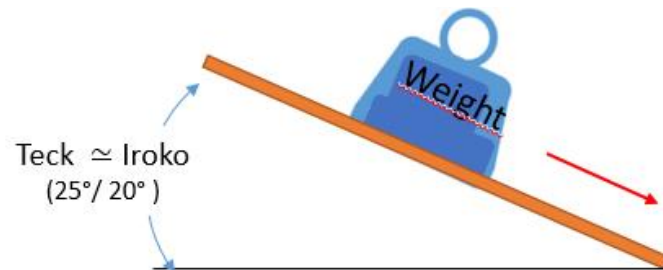

Stain resistance better than teak



	Teak	Iroko
Fioul	Importante marking	Light Marking
Oil	Importante marking	Importante marking
Red wine	Light Marking	OK
Coca Cola	OK	OK
Acetone	OK	OK
Ethanol	OK	OK

Humidity and temperature variations identical to teak

H° et T°

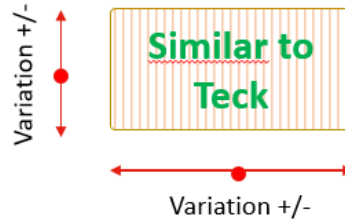

Weight similar to teak

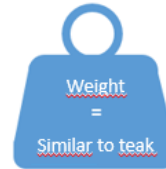

High-pressure cleaning: maintain a minimum distance of 15 cm

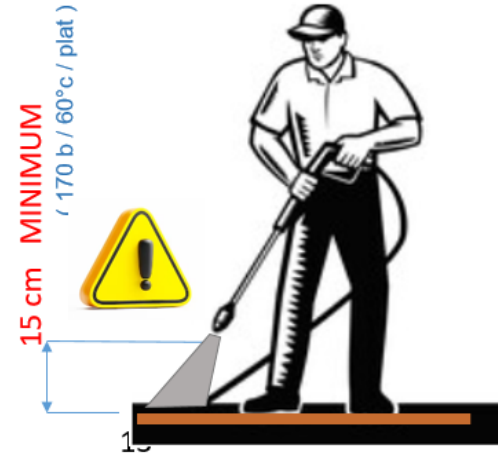

Stain

On delivery

After 4 days

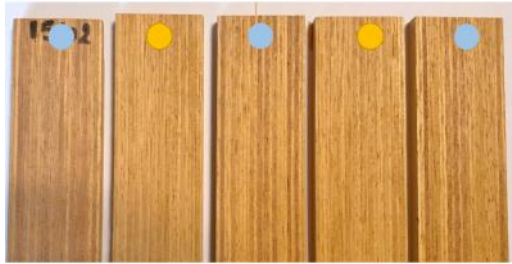

● Homogeneous Color

● NON-Homogeneous Color

Homogeneous ✓

Iro- Deck



Yellow stain



+1 or 2 days: Yellow stain



+ 8 months: Light grey

Teak



Orange-brown shade



+ 8 months: Deep grey stain



Iro-Deck on Oceanis 37.1:

As standard on:
Cockpit benches, aft platform, helm seats

As option :
Cockpit floor

Reminder:
the wooden parts of the cockpit tables are made of
Afzelia on all our models

The background is a solid blue color with several large, overlapping, semi-transparent curved shapes in a lighter shade of blue, creating a sense of depth and movement. The shapes are primarily located in the top-left and bottom-right corners.

Ambiance

INTERIOR AMBIANCE

Wood & Floor

		37.1
Alpi	Walnut	✓
	White oak	✓
Planchers	Laminated Rovere Alévé	✓
	Laminated brown oak (only with white oak)	✓

✓ = standard ✓ = option



STANDARD: Walnut alpi + Rovere Alévé floors



OPTION: White oak alpi + Rovere Alévé floors



OPTION: White oak alpi + Brown oak floors



INTERIOR AMBIANCE

INTERIOR UPHOLSTERY

37.1

Interior upholstery	Néo 05	✓
	Marlin Weiss	✓
	Winner Silver 139	✓
Covering on handrails	Cognac	✓



Néo 05



Marlin Weiss



Winner Silver 139

PADDING UPHOLSTERY

37.1

Saloon	Beige	✓
Cabins Included in Comfort trim level	Beige	✓
Saloon & Cabins	Macadamia	✓



Beige

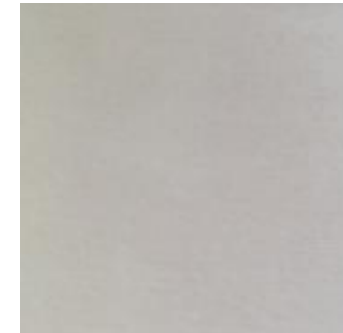

Macadamia

✓ = standard ✓ = option ✓ = trim level

OUTSIDE AMBIANCE

EXTERIOR UPHOLSTERY

		37.1
Assises de cockpit	Dolce 51	✓

HULL COLOR

		37.1
Hull color	White gel coat (RAL 9016) + hull decorated in metallic grey (3M50 58)	✓
	Pearl grey gel coat (RAL 7004) + hull decorated in white (Avery Dennison 800-01 PC Off White)	✓

✓ = standard ✓ = option

Dolce 51

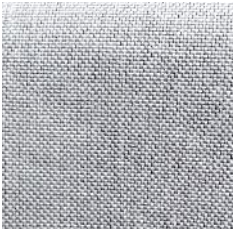

Gel-coat Gris Perle



COVERS - EXTERIOR PROTECTIONS

			37.1
Covers	Luxe cockpit table	Cadet Grey	✓
	Steering wheels		✓
Protections	Spayhood		
	Bimini		
Lazy Bag		Natural	✓

WOOD

			37.1
Cockpit benches - Platform	Iro-Deck	✓	
Cockpit floor		✓	

Cadet Grey

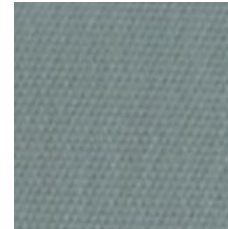

Iro-Deck



Exterior dimensions

Oceanis 37.1

E-BOOK



Exterior dimensions

Helmsman seat:
0,65 x 0,32 m /
2'2" x 1'1"

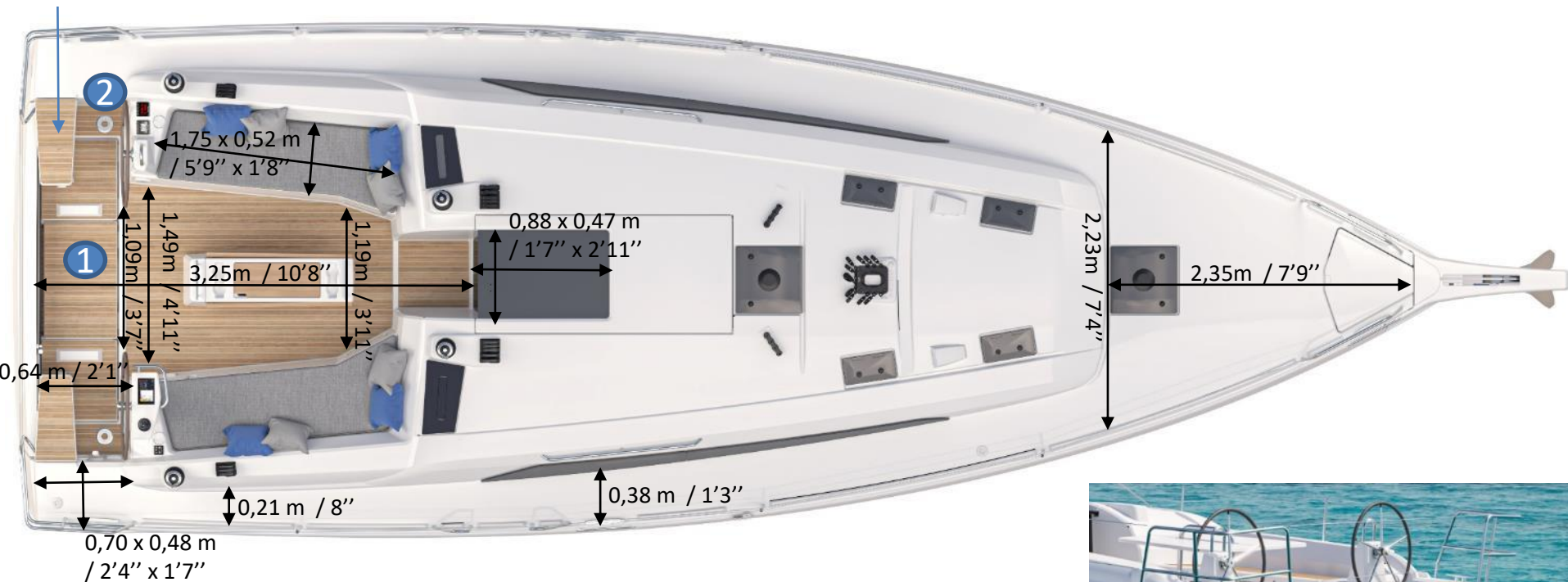

① BIB storage accessible from the platform and the cockpit floor.
Useful dimensions: 830mm x 545mm x 380mm / 2'9" x 1'9" x 1'3")

② Gas box – tilting door
(25 cm x 27 cm x 40 cm / 10" x 11" x 15")

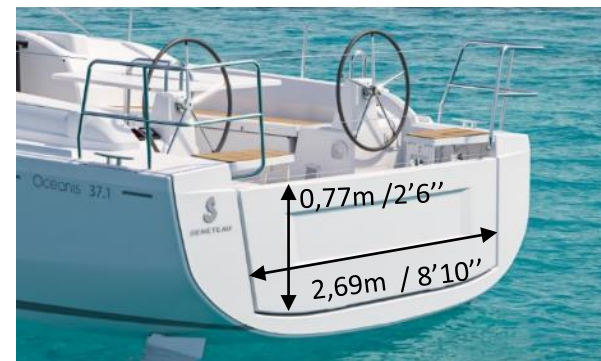

Exterior dimensions

Standard cockpit table



Luxe cockpit table

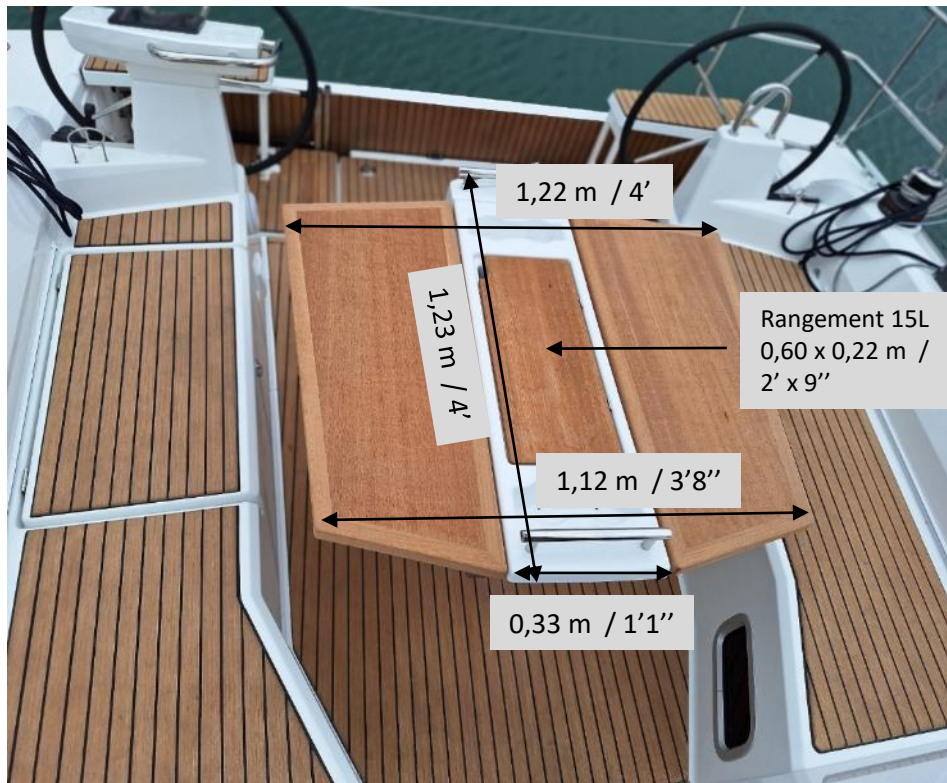

Interior dimensions & headrooms

Oceanis 37.1

E-BOOK



Headrooms

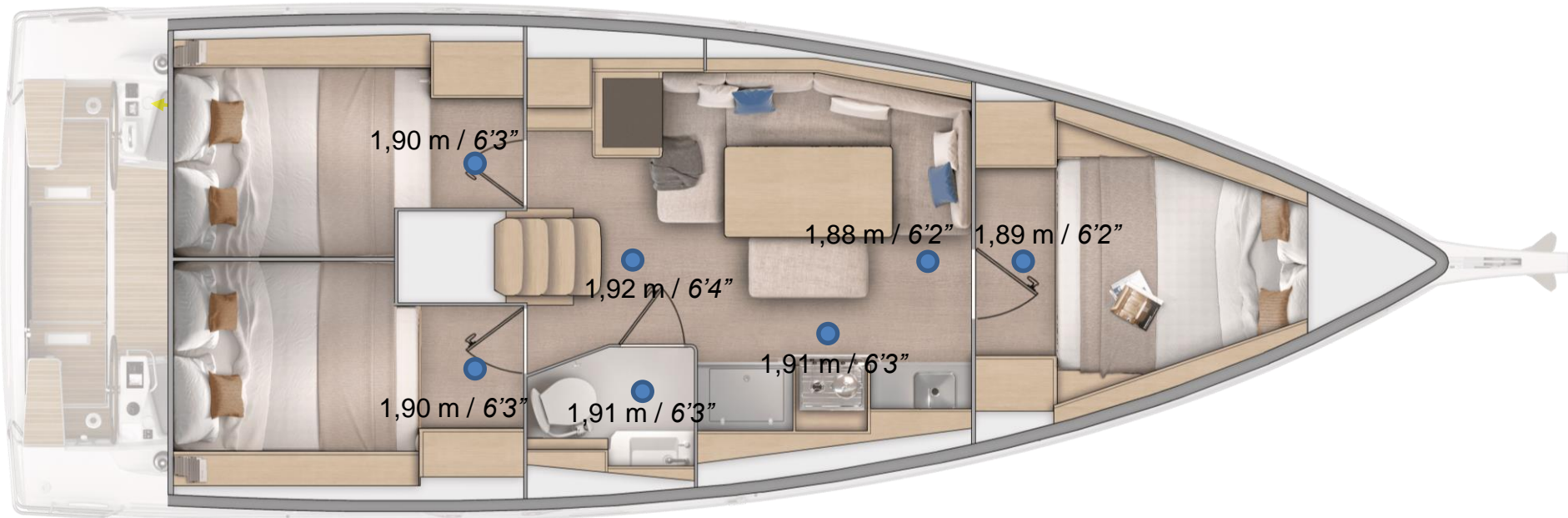

Interior dimensions

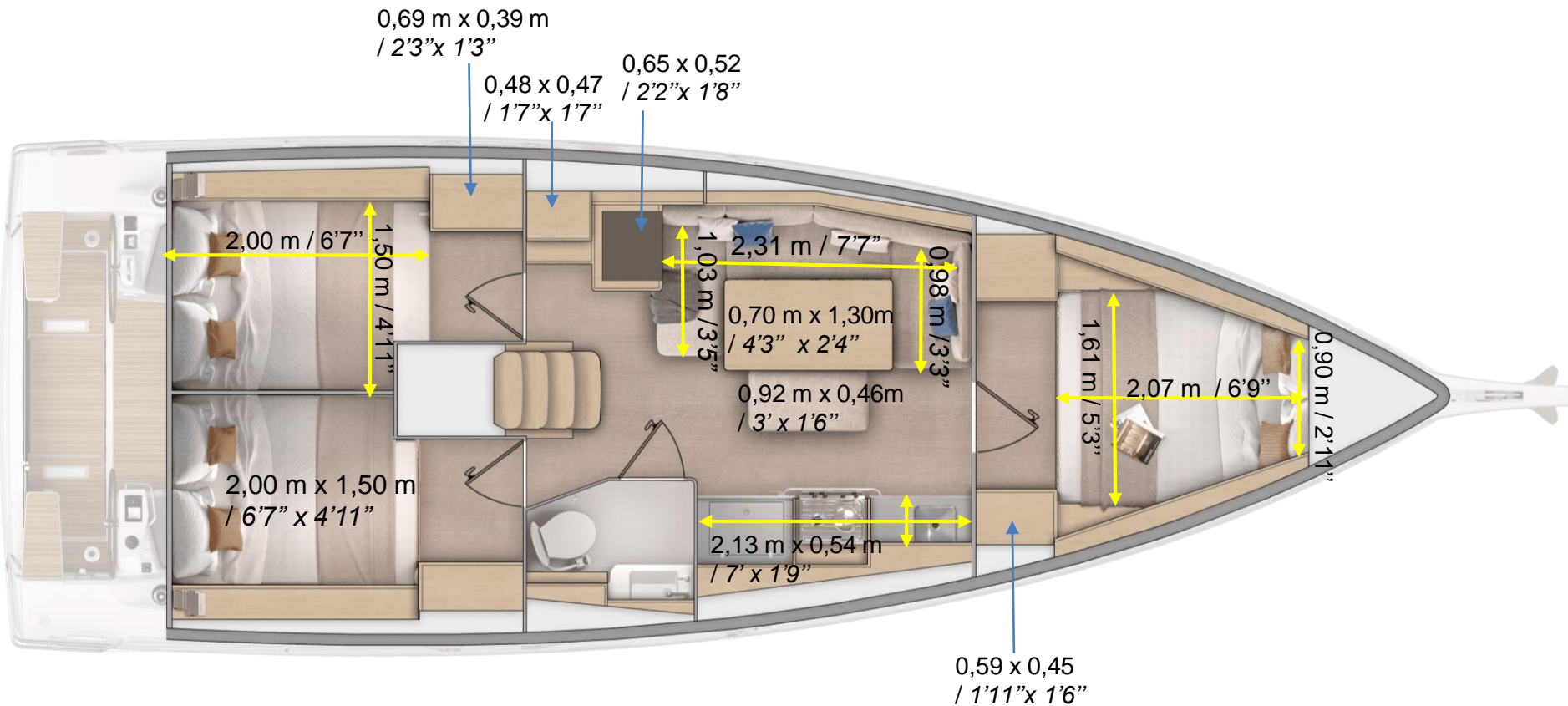

Port aft cabin in 2C1H version

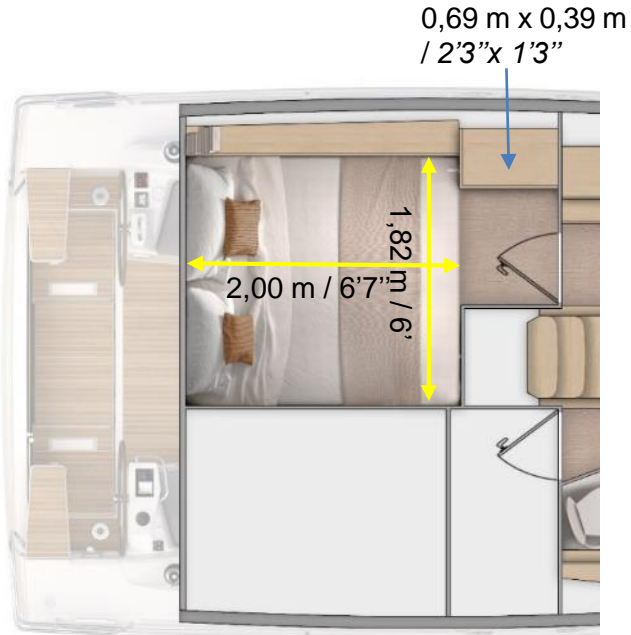

Forward cabin in 3C2H version

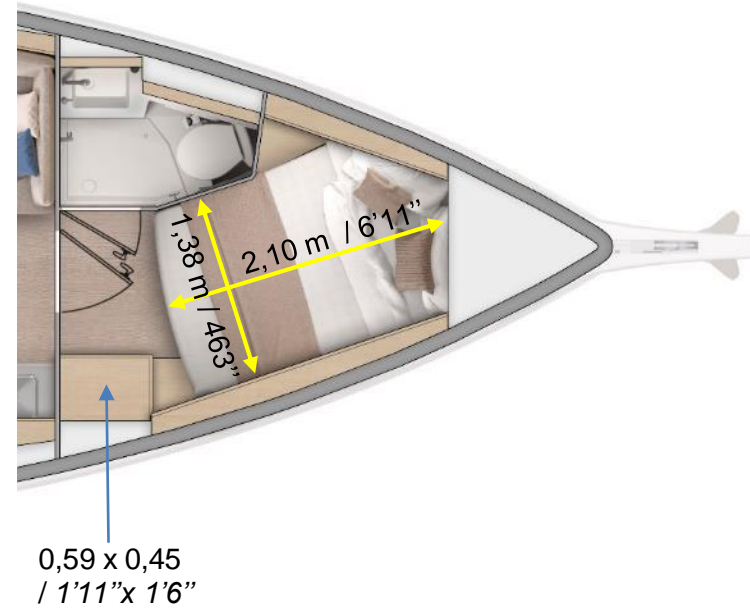

Technical equipments location

Technical equipments location

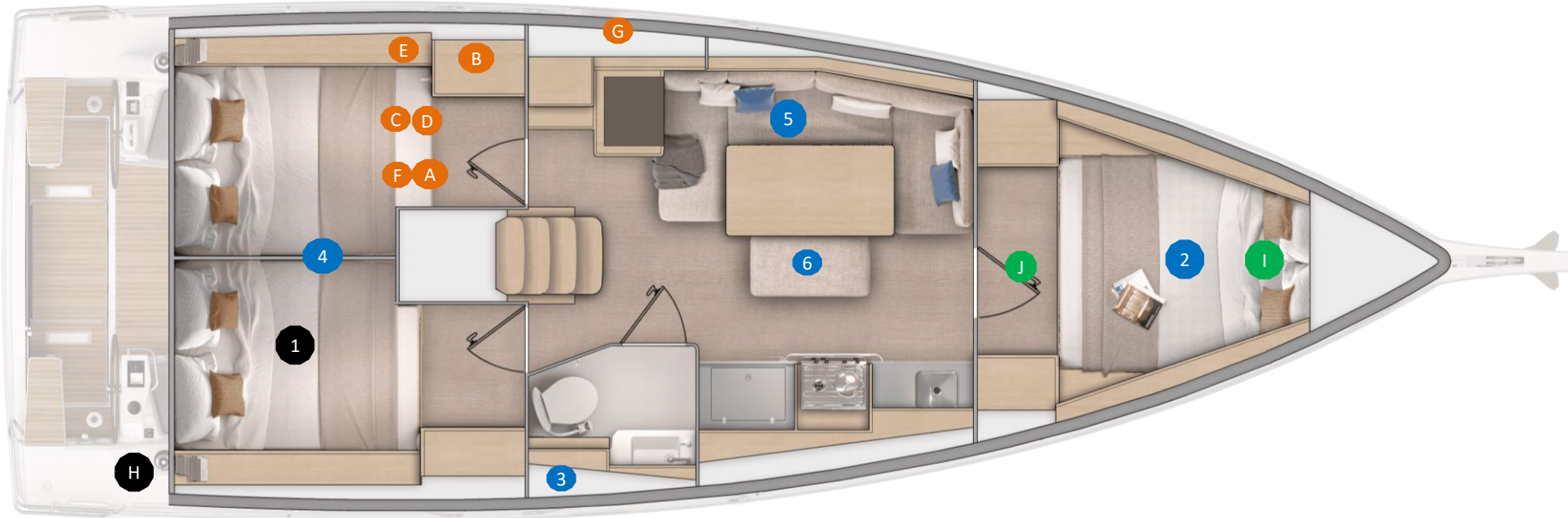

1 Fuel tank 130 L / 34 US Gal- standard

2 Freshwater tank 330 L / 87 US Gal -- standard

3 Holding tank – 80 L / 21 US Gal - standard

4 Water heater 25 L / 7 US Gal- standard

5 Plumbing board (accumulator tank-water units.....)

6 Bilge pump

A Electrical panel

B 2 000 VA 12 V – 230 V Inverter – option

C 1 AGM (100 Ah) service battery , trim level

D 1 additional 195 Ampères service battery, trim level

E 1 Battery charger(40 Ah) , trim level

F 1 AGM (50 Ah) engine battery, trim level

G 12V Electrical panel

I Bow thruster option

J Sensor option

H 5 500W boiler - option

Electricity location



Heating system

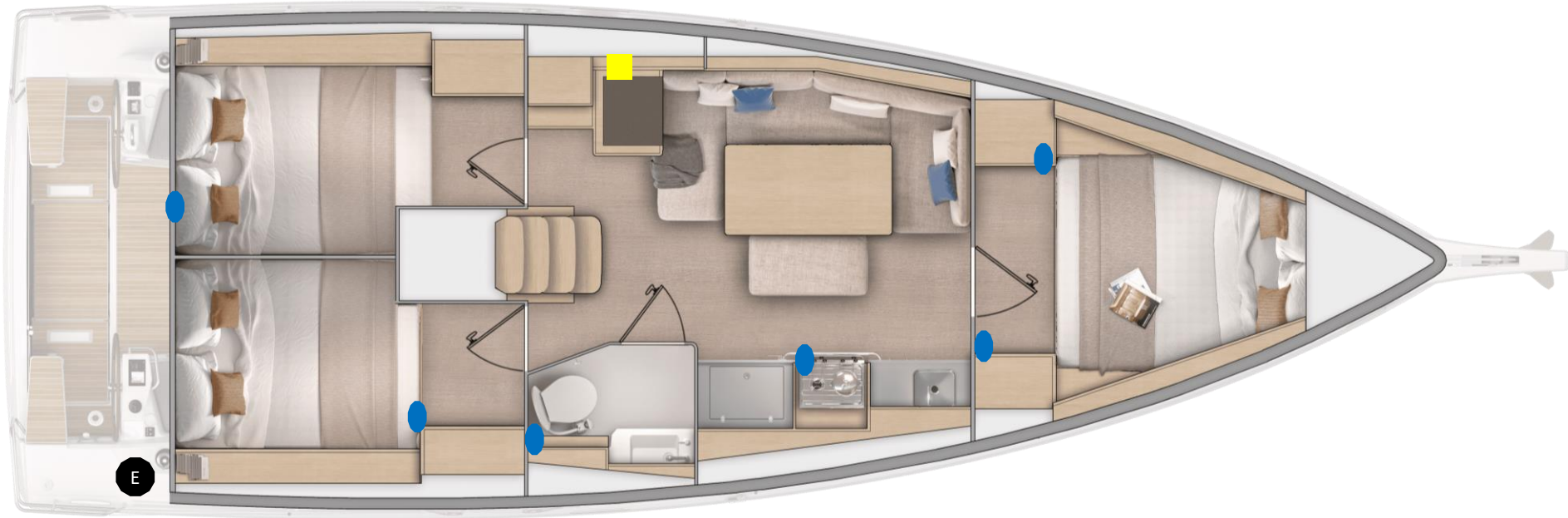

E 5 500W Boiler - option

 Hot air outlet

 Thermostat

! Heating not compatible with air conditioning

Air conditioning

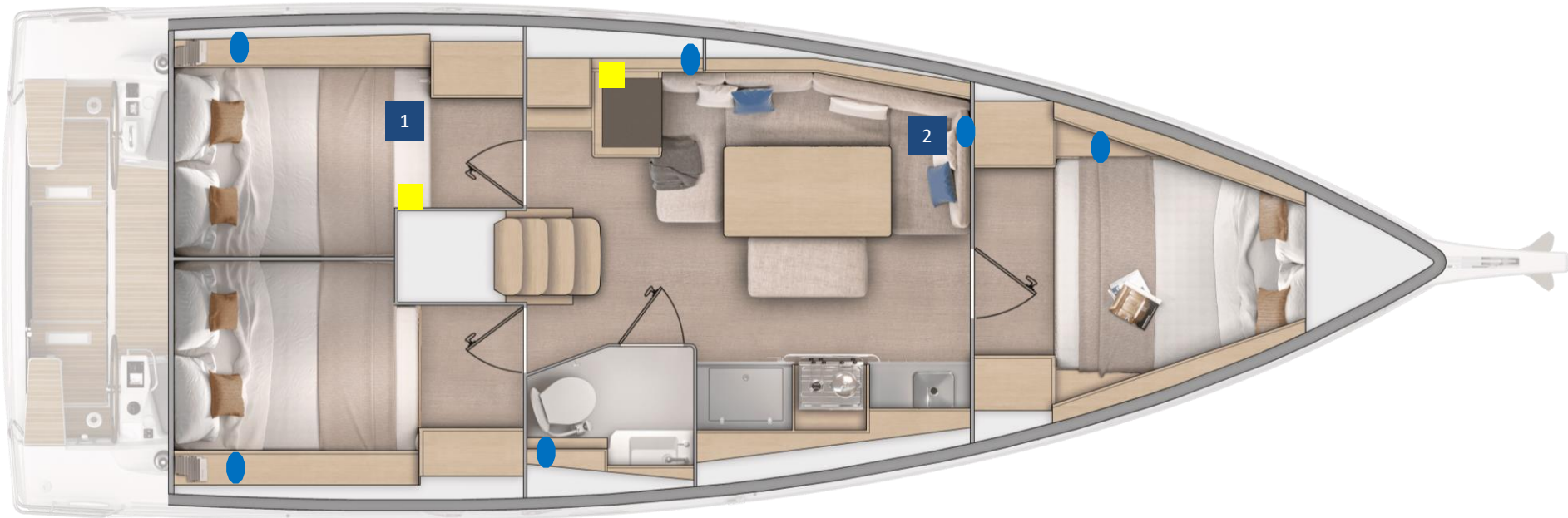

1 8 000 BTU air conditioning unit

2 16 000 BTU air conditioning unit

 Air conditioning outlet

 Thermostat

! Air conditioning not compatible with heating